

**Summary of Consultation Information Sent to the Howick Local Board in
October 2017**

Project	Description of Proposal	Dates
Eastern New Network Bus Stops and Shelters	The approx. 110 significant changes to bus stops and shelters required for the Eastern New Network. Auckland Transport worked through all of these proposed changes with the HLB. Sending out lists and maps then conducting workshops with the HLB to confirm details and allow Members to discuss the changes.	Throughout October 2017
Eastern New Network Intersections	<p>Auckland Transport has informed the HLB that it is proposed that the following intersections are modified to improve efficiency:</p> <p><u>Aviemore / Bradbury, Howick</u></p> <ul style="list-style-type: none"> • Requires a kerb cutback of left turn from Bradbury Rd • Shifting the centre line exiting Bradbury <p><u>Bradbury / Union Roundabout, Howick</u></p> <ul style="list-style-type: none"> • Requires realignment of centre line on exit of Bradbury Rd <p><u>Meadowlands / Sandspit, Howick</u></p> <ul style="list-style-type: none"> • Requires a kerb cutback of left turn from Sandspit Rd • Pedestrian island on Sandspit to be narrowed • Centre line on Sandspit to be realigned • Broken yellow lines extended from corner on Meadowlands Dr resulting in the loss of one car space <p><u>Ormiston / Haddington, Flat Bush</u></p> <ul style="list-style-type: none"> • Requires a kerb cutback of left turn from Ormiston Rd • Centre line realignment of exit on Haddington Dr • Reduced width of advance cycle box on right turn lane exit of Haddington <p><u>Haddington / Brookview, Flat Bush</u></p> <ul style="list-style-type: none"> • Extension of broken yellow lines from roundabout on Brookview Dr 	16 October 2017
Michael Boshier Way	Install parking controls (No Stopping at All Times') that were approved as part of the Resource Consent. The attached plan shows the proposed controls.	Circulated 3 Nov 17

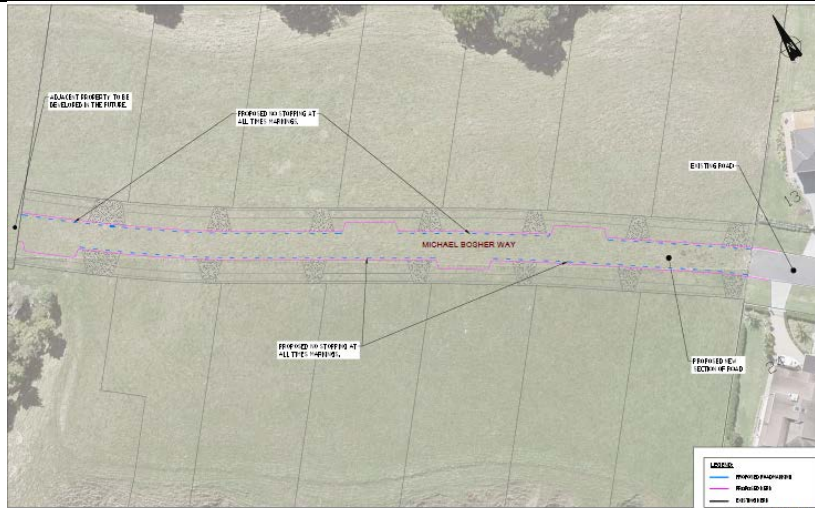

Ormiston Intersection Parking Controls

Parking controls around intersections being built in Ormiston. Some roads are not named but are in the vicinity of Te Irirangi, Ormiston and Bishop Roads.

Circulated 17 Oct 17

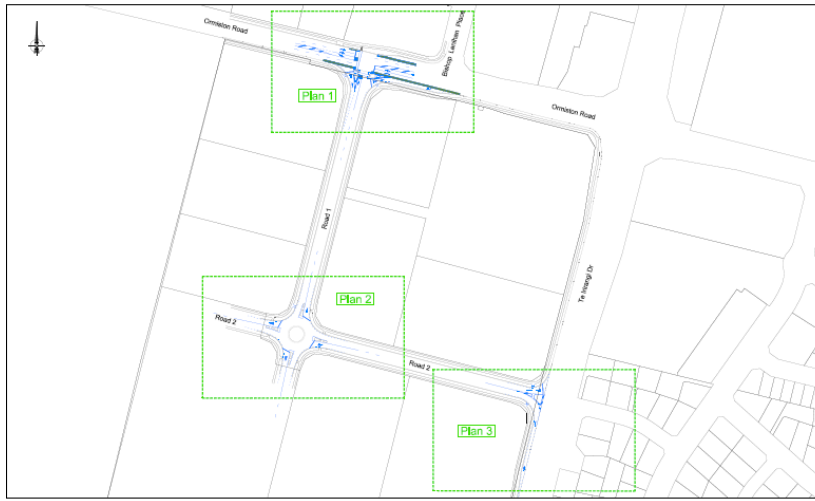

<table border="1"> <tr><td>DATE</td><td>17/10/17</td></tr> <tr><td>SCALE</td><td>1:500</td></tr> <tr><td>DWG NO</td><td>101216411A</td></tr> </table>	DATE	17/10/17	SCALE	1:500	DWG NO	101216411A	<p>79 ORMISTON ROAD, TRAFFIC AND PARKING RESOLUTION OVERALL CONSULTATION PLAN</p>	<table border="1"> <tr><td>DATE</td><td>17/10/17</td></tr> <tr><td>SCALE</td><td>1:500</td></tr> <tr><td>DWG NO</td><td>101216411A</td></tr> </table>	DATE	17/10/17	SCALE	1:500	DWG NO	101216411A	<p>TDC 0</p>
DATE	17/10/17														
SCALE	1:500														
DWG NO	101216411A														
DATE	17/10/17														
SCALE	1:500														
DWG NO	101216411A														

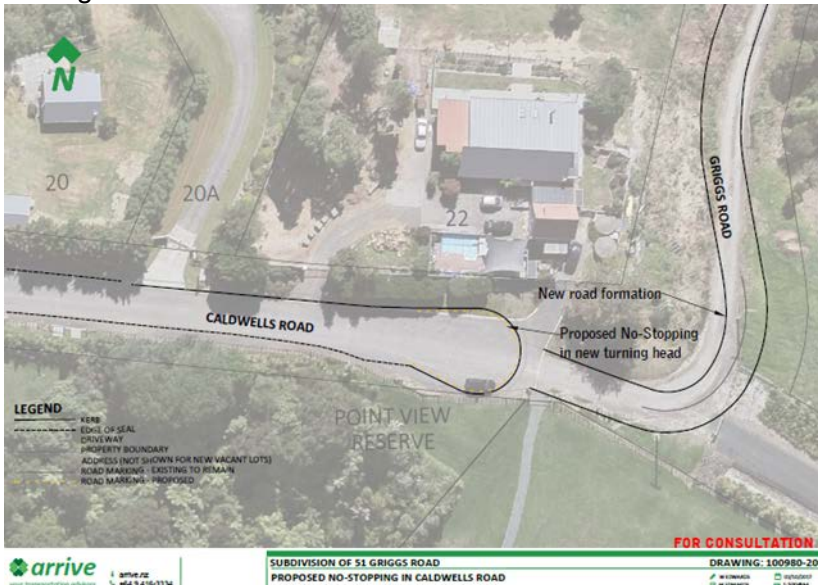
<p>Griggs Road</p>	<p>The project involves the formation of a new carriageway in the western end of the previously unformed Griggs Road.</p> <p>A condition of consent required the formation of a new turning head in Caldwell's Road (West) where it intersects with Griggs Road, and the installation of a no-stopping control in the new turning head.</p> 	<p>Circulated 17 Oct 17</p>
--------------------	---	-----------------------------

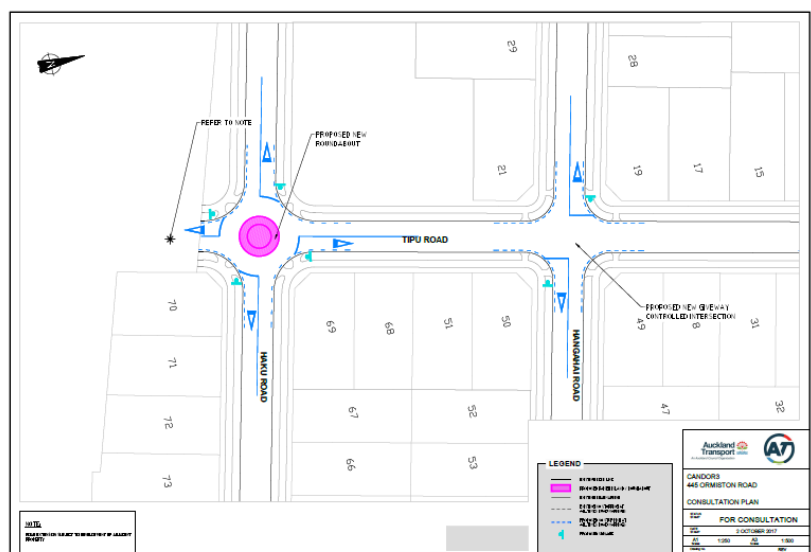
<p>Ormiston Stage 5</p>	<p>Parking controls around intersections being built in Ormiston. Hangahai, Haku and Tipu Roads</p> 	<p>Circulated 17 Oct 17</p>
-------------------------	--	-----------------------------