

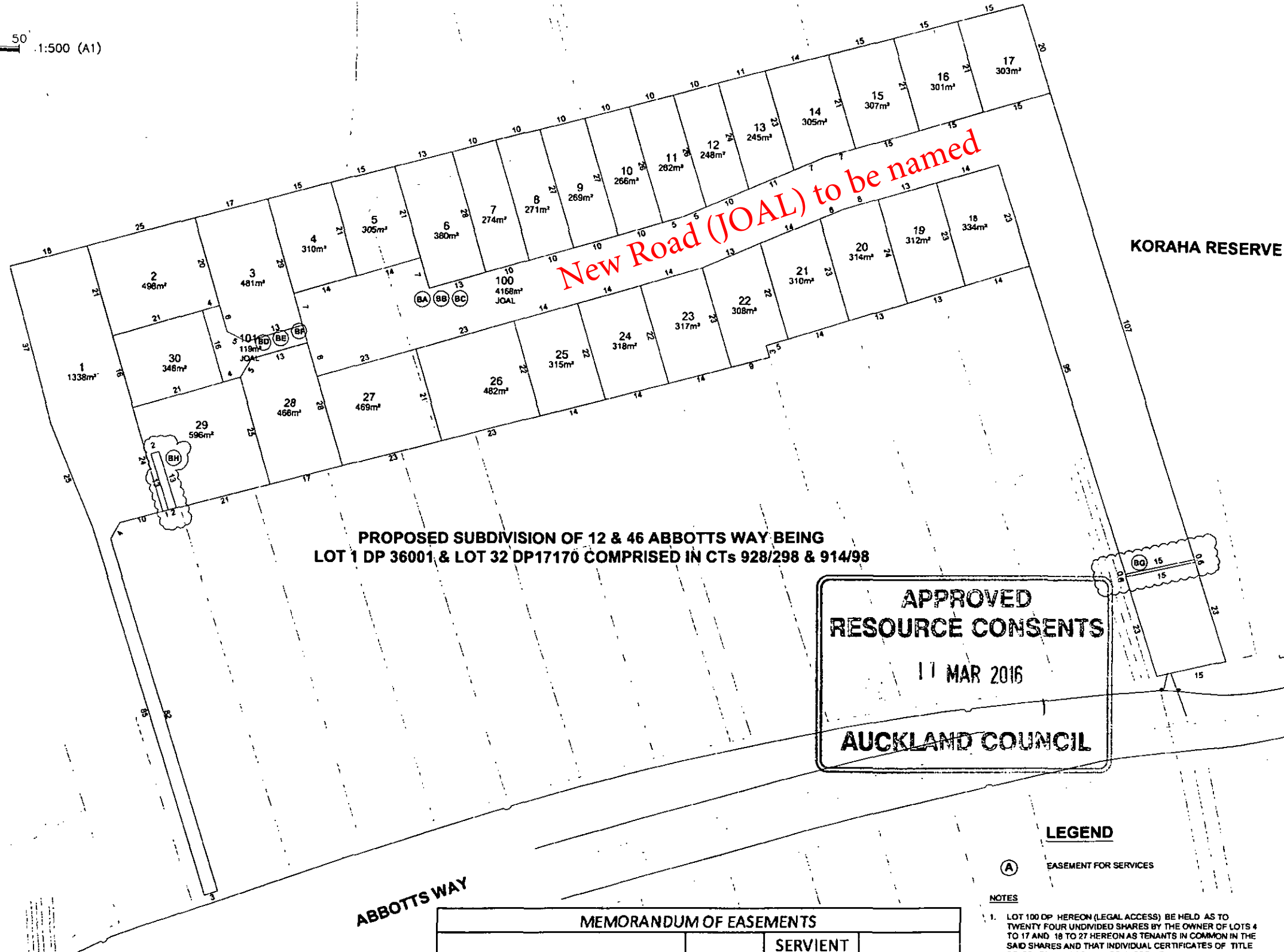

10 0 10 20 30 40 50
DIMENSIONS ARE IN METRES 1:500 (A1)



PROPOSED SUBDIVISION OF 12 & 46 ABBOTTS WAY BEING
LOT 1 DP 36001 & LOT 32 DP17170 COMPRISED IN CTs 928/298 & 914/98

**APPROVED
RESOURCE CONSENTS**
11 MAR 2016
AUCKLAND COUNCIL

LEGEND

(A) EASEMENT FOR SERVICES

NOTES

- LOT 100 DP HEREON (LEGAL ACCESS) BE HELD AS TO TWENTY FOUR UNDIVIDED SHARES BY THE OWNER OF LOTS 4 TO 17 AND 18 TO 27 HEREON AS TENANTS IN COMMON IN THE SAID SHARES AND THAT INDIVIDUAL CERTIFICATES OF TITLE BE ISSUED IN ACCORDANCE THEREWITH.
- LOT 101 DP HEREON (LEGAL ACCESS) SHALL BE HELD AS TO FIVE UNDIVIDED SHARES BY THE OWNER OF LOTS 2 TO 3 AND 28 TO 30 HEREON AS TENANTS IN COMMON IN THE SAID SHARES AND THAT INDIVIDUAL CERTIFICATES OF TITLE BE ISSUED IN ACCORDANCE THEREWITH.
- THIS PLAN AND ACCOMPANYING REPORT(S) HAVE BEEN PREPARED FOR THE PURPOSES OF OBTAINING RESOURCE CONSENT ONLY AND FOR NO OTHER PURPOSE WHATSOEVER. USE OF THIS PLAN AND/OR THE INFORMATION ON IT FOR ANY OTHER PURPOSE IS AT THE USER'S RISK.
- AREAS AND MEASUREMENTS SUBJECT TO FINAL LAND TRANSFER SURVEY.
- TOTAL AREA - 15418m²
- EXISTING SEWER (BG) POSITION BASED ON INFORMATION FROM MEMORANDUM OF TRANSFER 563326 DATED 05/08/1955
- EXISTING DRAINAGE (BH) POSITION BASED ON INFORMATION FROM MEMORANDUM OF TRANSFER 354553 DATED 02/02/1943

MEMORANDUM OF EASEMENTS

PURPOSE	SHOWN	SERVIENT TENEMENT	GRANTEE
ELECTRICITY, GAS	BA	100	VECTOR
TELECOMMUNICATIONS	BB	100	CHORUS
WATER SUPPLY	BC	100	WATERCARE
ELECTRICITY, GAS	BD	101	VECTOR
TELECOMMUNICATIONS	BE	101	CHORUS
WATER SUPPLY	BF	101	WATERCARE
EXISTING SEWER	BG	100	PRIVATE
EXISTING DRAINAGE	BH	29	PRIVATE

PROJECT
**12 & 46 ABBOTTS
WAY, REMUERA**

CLIENT
**HB INTERNATIONAL
DEVELOPMENT (NZ)
LTD**

115 HIRANGIA ROAD, ROAD 1
PAPAKURA 2580
AUCKLAND
CONSULTANT

AECOM New Zealand Limited
AECOM House, 8 Mahuhu Crescent,
AUCKLAND 1010, Auckland, NZ 1010
+64 9 967 9200 tel +64 9 967 9201 fax
www.aecom.com

RECEIVED
24 JUL 2015

PROJECT MANAGEMENT INITIALS

JL	MG	MG
DESIGNER	CHECKED	APPROVED

ISSUE/REVISION

NO	DATE	DESCRIPTION
C	21.07.15	SEWER EASEMENT ADDED
B	17.07.15	LOTS UPDATED
A	25.06.15	RESOURCE CONSENT ISSUE

KEY PLAN

PROJECT NUMBER

60337639

SHEET TITLE

SUBDIVISION SCHEME
PLAN

SHEET NUMBER

-CV-0009