

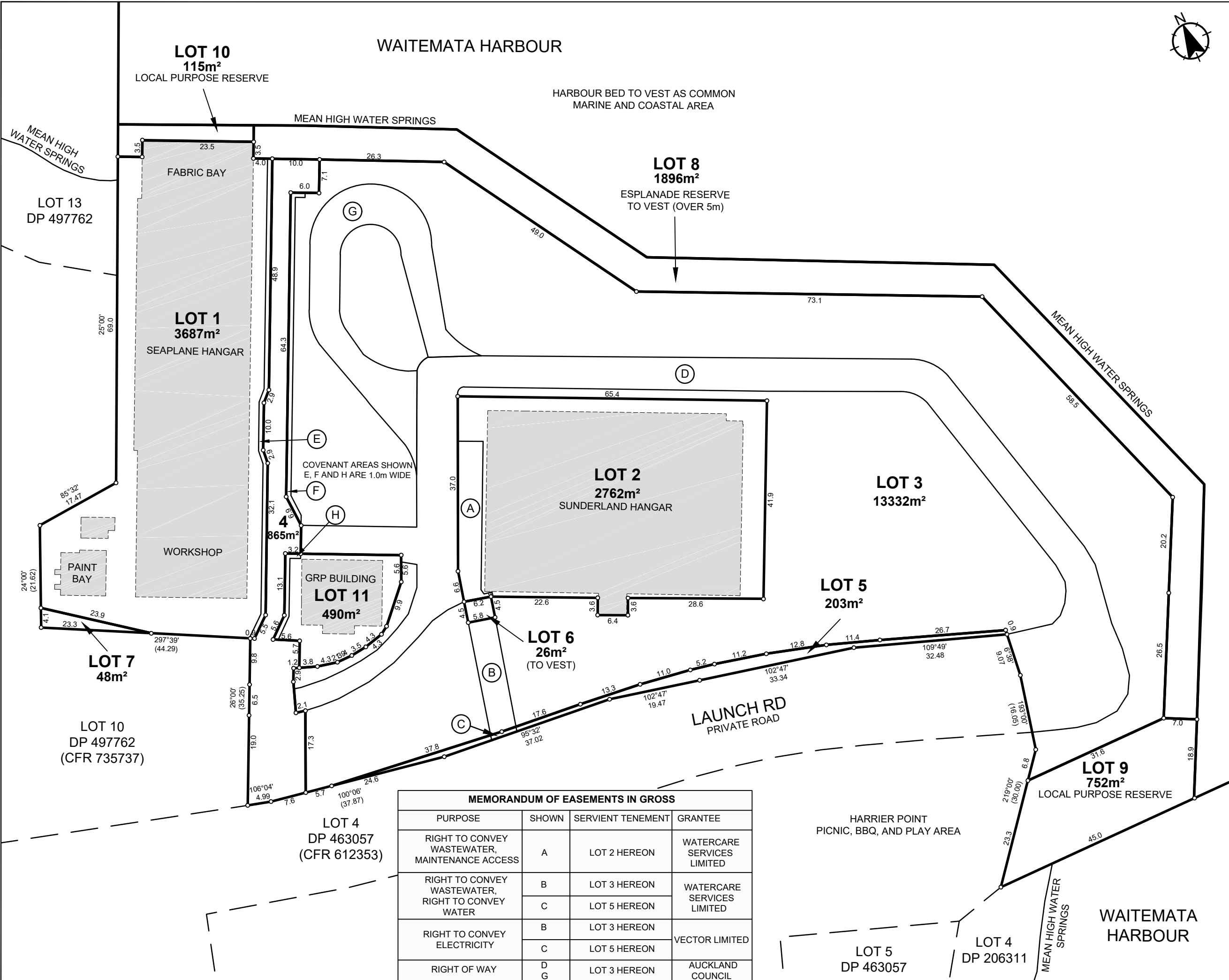

WAITEMATA HARBOUR



- NOTES:**
- AREAS AND MEASUREMENTS SHOWN ON THIS PLAN ARE SUBJECT TO FINAL SURVEY.
 - DIMENSIONS SHOWN RELATE TO PRIMARY PARCELS ONLY.
 - LOTS 1 - 10 AREA: 2.4177 ha
 - UNDERLYING CT REF: 735734 - LOT 11 DP 497762 697760 - PT HARBOUR BED SO 60255
 - AREAS SHOWN E, F AND H ARE TO BE SUBJECT TO LAND COVENANTS.

- AMALGAMATION CONDITIONS:**
- THAT LOT 1 HEREON AND LOT 2 HEREON BE HELD IN THE SAME COMPUTER FREEHOLD REGISTER.
 - THAT LOT 5 HEREON BE TRANSFERRED TO THE OWNERS OF LOT 4 DP 463057 (CFR 612353) AND THAT ONE COMPUTER FREEHOLD REGISTER BE ISSUED TO INCLUDE ALL PARCELS.
 - THAT LOT 7 HEREON BE TRANSFERRED TO THE OWNERS OF LOT 10 DP 497762 (CFR 735737) AND THAT ONE COMPUTER FREEHOLD REGISTER BE ISSUED TO INCLUDE ALL PARCELS.

- LOTS TO VEST IN AUCKLAND COUNCIL:**
- LOT 3 DP 211237
 - PT LOT 2 DP 330629
 - LOT 8 - ESPLANADE RESERVE
 - LOT 6 - PUMP STATION
 - LOT 9 - LOCAL PURPOSE RESERVE
 - LOT 10 - LOCAL PURPOSE RESERVE

- LOTS TO BE VESTED AS PUBLIC ROADS**
- LOT 4 - FERRY TERMINAL ACCESS

10 EASEMENT AND LOT BDY UPDATE	RT	31.08.17
9 EASEMENT AND LOT BDY UPDATE	RT	31.08.17
8 EASEMENT AND LOT BDY UPDATE	RT	30.08.17
7 RESOURCE CONSENT REVISION	RT	30.08.17
Revision	App	Date
Surveyed TM	NOV 16	
Designed		
Drawn TM	JAN 17	
Reviewed TM	JAN 17	
Approved RT	JAN 17	

Verify all dimensions on site before commencing work. Prioritise figured dimensions over scaling. Refer all discrepancies to Calibre. This document and the copyright in this document remain the property of Calibre Consulting Limited. The contents of this document may not be reproduced either in whole or in part by any means whatsoever without the prior written consent of Calibre Consulting Limited.



Client
Hobsonville Land Company

Project Title
THE LANDING PRECINCT
HOBSONVILLE POINT

Sheet Title
LOTS 1-11 BEING SUBD. OF LOT 11
DP 497762, PT. WAITEMATA HARBOUR
BED SO 60255, LOT 3 DP 211237, AND
PT. LOT 2 DP 330629

Level 1, Building 8, 666 Great South Rd | calibreconsulting.co
Eilerslie, Auckland 1542 | +64 9 525 9770



Scale (A3 Original) 1:750
7.5 3.75 0 7.5 15 22.5
m

Project No	Sheet	Revision
709900	V201	10

MEMORANDUM OF EASEMENTS IN GROSS			
PURPOSE	SHOWN	SERVIENT TENEMENT	GRANTEE
RIGHT TO CONVEY WASTEWATER, MAINTENANCE ACCESS	A	LOT 2 HEREON	WATERCARE SERVICES LIMITED
RIGHT TO CONVEY WASTEWATER, RIGHT TO CONVEY WATER	B	LOT 3 HEREON	WATERCARE SERVICES LIMITED
	C	LOT 5 HEREON	
RIGHT TO CONVEY ELECTRICITY	B	LOT 3 HEREON	VECTOR LIMITED
	C	LOT 5 HEREON	
RIGHT OF WAY	D	LOT 3 HEREON	AUCKLAND COUNCIL
	G	LOT 3 HEREON	