

KEY

- | | | | |
|-----------------------|--------------------------------------|-------------------------------------|-----------------------|
| Park boundary | Shrub planting | Existing rock border | Existing park signage |
| Existing trees | Lawn areas | Site furniture: seats/picnic tables | Tennis court fencing |
| Trees to be relocated | Proposed exposed aggregate footpaths | Rubbish bins | Timber bollards |
| Proposed trees | Bark cushionfall | Drinking fountain | |
| | | Cycle racks | |

LEGEND

- 1 Replace existing hardstand to the left hand side of the Foch Ave entrance with planting.
- 2 Proposed tree/hedge planting along fenceline to provide visual screening to neighbouring properties along south-west and south-eastern boundaries.
- 3 Remove existing tennis courts and return area to lawn
- 4 Renew bounce wall in conjunction with tennis court upgrade
- 5 Addition of 4 proposed cycle racks and drinking fountain outside Tennis Club building.
- 6 Upon footpath renewal, realign and straighten existing footpath from Foch Ave entry to Tennis Club.
- 7 **Existing children's playground** (note: equipment shown is indicative only).
 - a. inclusion of ramp off footpath to improve access into playspace
 - b. investigate the inclusion of additional playground items into existing playspace i.e. marble runs
 - c. investigate the removal of existing keyboard play equipment
 - d. investigate the feasibility of shifting the tall climbing module away from the fenceline towards the tennis court, place low equipment beside fence.
 - e. when playground is up for renewal ensure tall equipment is located away from boundary
- 8 When playground equipment is relocated or renewed (refer note 7) plant boundary with trees, and shrubs to provide visual screening for neighbouring properties.
- 9 Court hardstand to be reduced in width by 3m to accommodate a 1.8m wide exposed aggregate concrete path running through the reserve from Hazel Ave to the carpark off Foch Ave. Existing lights along fenceline and within hardstand to be removed.
- 10 Relocate tennis court boundary fencing to accommodate proposed concrete path and add extra gated court entrance.
- 11 Upgraded tennis courts to have moveable nets to accommodate a wider range of multi sport activities, i.e. netball, basketball and volleyball and informal activities including Tai Chi, boot camp, learn-to-ride and informal play.
- 12 Existing tree to be relocated to accommodate path through reserve.
- 13 Investigate provision off all abilities ramped access to VHF club with access located adjacent to mobility carpark and loading bay.
- 14 Proposed 11 space Hazel Ave carpark, including 1 mobility carpark. High kerb to carpark edge to deter vehicles from driving onto adjacent lawn area. Inclusion of lockable gate at carpark entrance.
- 15 Carpark to include 1 mobility carpark and loading zone with kerb ramp to adjacent footpath to assist with transferring equipment between truck and building.
- 16 Remove invasive bamboo along site boundary and replace with native screen planting.
- 17 Relocate existing table tennis table to accommodate proposed carpark.
- 18 Proposed bollards at 1.5m centres along Hazel Ave boundary to restrict vehicle access to the grass area.
- 19 Proposed specimen trees.
- 20 Investigate adding dotted yellow lines near the driveway entrance on Hazel Ave to improve access into reserve (Auckland Transport involvement required).
- 21 Proposed footpath along Hazel Ave to connect up to park path. Consultation with arborist required as path located within the rootplate of the Fig tree (Auckland Transport involvement required).
- 22 Remove reference to 'Mt Roskill Scouts' from the park sign on Hazel Ave. Upon renewal relocate the new sign closer to the road.
- 23 Maintain open lawn area for informal sports.

LONG TERM OPTION

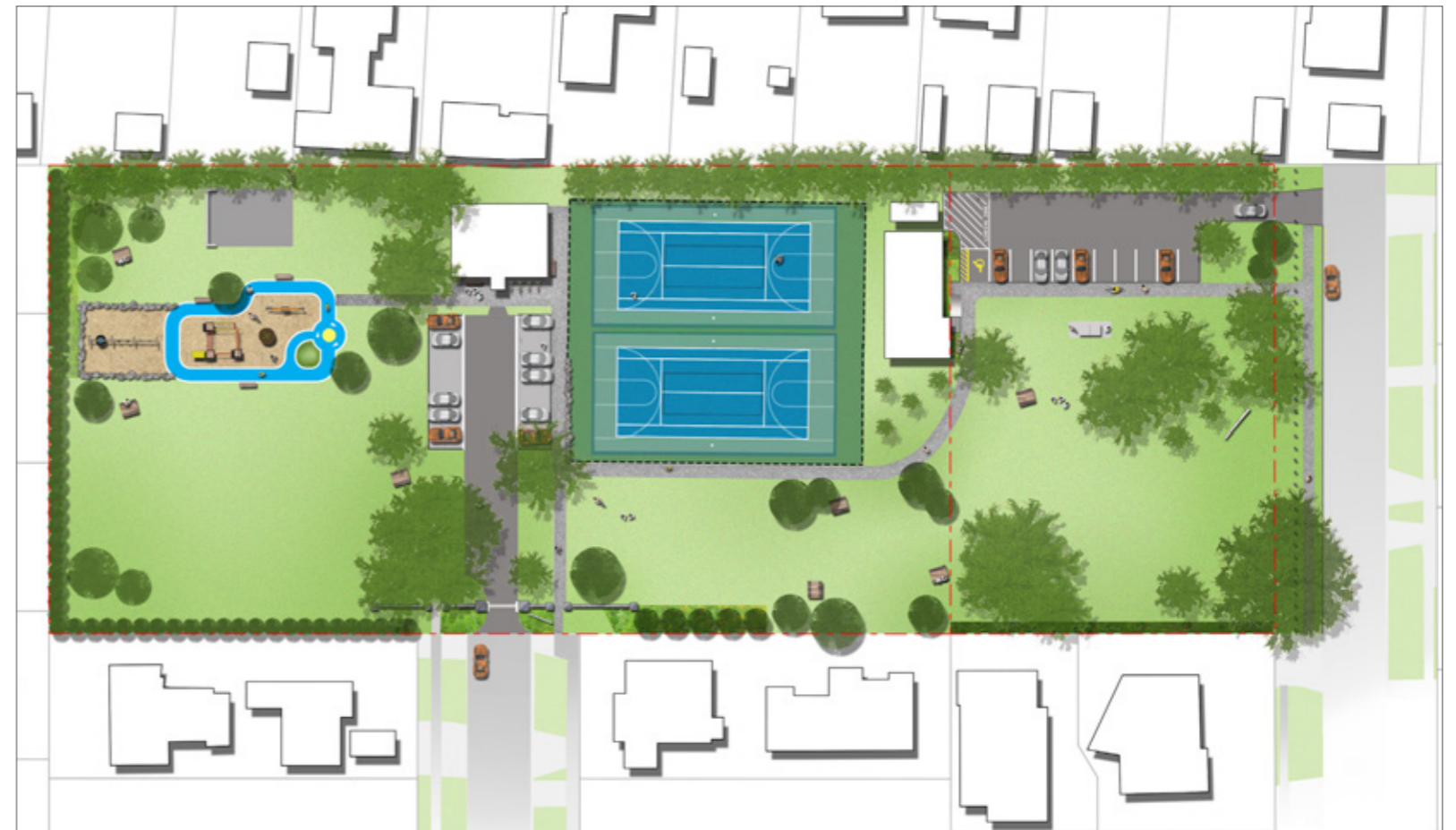

This is an aspirational / long term plan. It proposes the relocation of the children's playground from its current location (note: the playground equipment and layouts shown above are indicative only). It includes the integration of a learn-to-ride bike track into the playspace to counteract the loss of this activity with the two central court becoming a tennis and multi sports facility

This layout reduces the pinch point between the current playground and tennis courts, opens up sightlines into the park from Hazel Ave and provides a continuous green link from the front to the back of the reserve.