

**PLAN**  
1:20

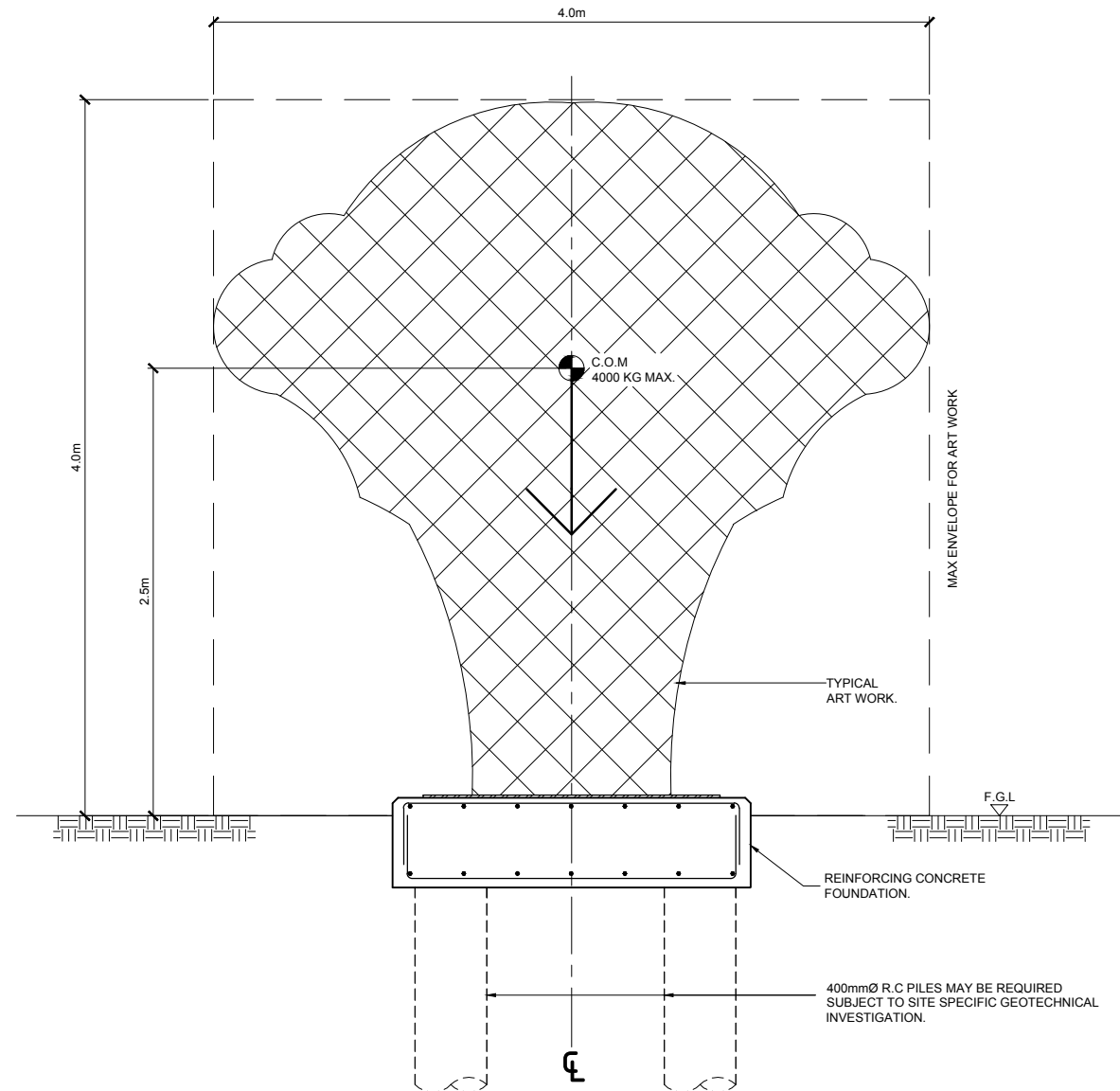

**ELEVATION**  
1:20

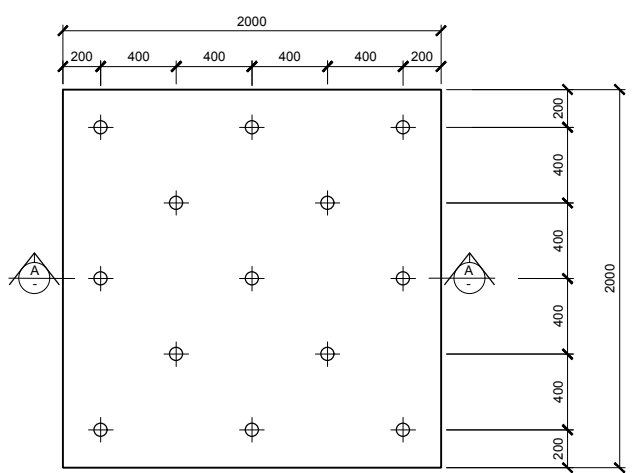

**FOUNDATION PLAN**  
1:20  
(SHOWING SETOUT FOR THREADED INSERTS (TBC))

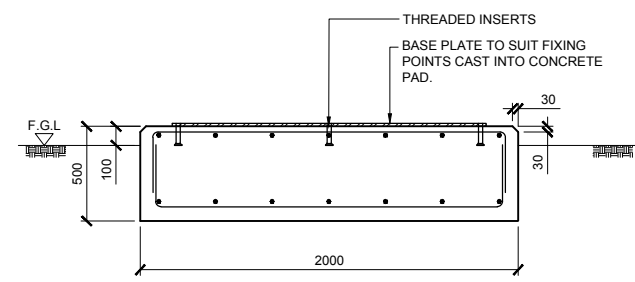

**SECTION A-A**  
1:20

**NOT FOR CONSTRUCTION  
CONCEPT ONLY**

- NOTES:**
- CONCRETE STRENGTH  $f_c = 25\text{MPa}$  MINIMUM @ 28 DAYS
  - FOUNDATION PAD DESIGNED ASSUMED GOOD GROUND CONDITION WITH 100 kPa ALLOWABLE SOIL BEARING PRESSURE.
  - SPECIFIC BRIDGING DESIGN REQUIRED IF FOUNDATION PAD WITHIN THE ZONE OF INFLUENCE OF PUBLIC DRAIN & SERVICES.
  - ALL GRADE 500MPa STEEL IS TO BE MICRO ALLOY (MA). NO GRADE 500MPa STEEL IS TO BE REBENT.

**Mitchell Vranjes**  
CONSULTING ENGINEERS  
■ Ground Floor 2 Karl Street Grafton Auckland  
Box 65248 Mairangi Bay Ph.307-2141 Fax.307-2143  
■ 2nd Floor 37 Elliott Street Papakura  
Box 72-799 Papakura Ph.298-8800 Fax.298-9920

Job Title:  
**PROPOSED SUFFRAGE FOUNDATION:  
AUCKLAND COUNCIL**

Sheet Title:  
PLAN, ELEVATION & DETAILS

Scale: 1:20 (A1)	Job No: 18/09
Date: MAY 2018	Dwg. No: S.1
Design: NICK.C	Drawn: TED.G
Revisions:	