



Title Plan - SO 524772

Survey Number SO 524772
Surveyor Reference 20181720
Surveyor Ian Derek Walker
Survey Firm Ascension Surveyors Ltd
Surveyor Declaration I Ian Derek Walker, being a licensed cadastral surveyor, certify that:
 (a) this dataset provided by me and its related survey are accurate, correct and in accordance with the Cadastral Survey Act 2002 and the Rules for Cadastral Survey 2010, and
 (b) the survey was undertaken by me or under my personal direction.
 Declared on 03 Jul 2018 11:19 AM

Survey Details

Dataset Description	Sections 1 to 3		
Status	Approved as to Survey		
Land District	North Auckland	Survey Class	Class A
Submitted Date	03/07/2018	Survey Approval Date	04/07/2018
		Deposit Date	

Territorial Authorities

Auckland Council

Created Parcels

Parcels	Parcel Intent	Area	CT Reference
Section 1 Survey Office Plan 524772	Legalisation	2.2659 Ha	
Section 2 Survey Office Plan 524772	Legalisation	2.0171 Ha	
Section 3 Survey Office Plan 524772	Legalisation	0.7132 Ha	
Total Area		4.9962 Ha	

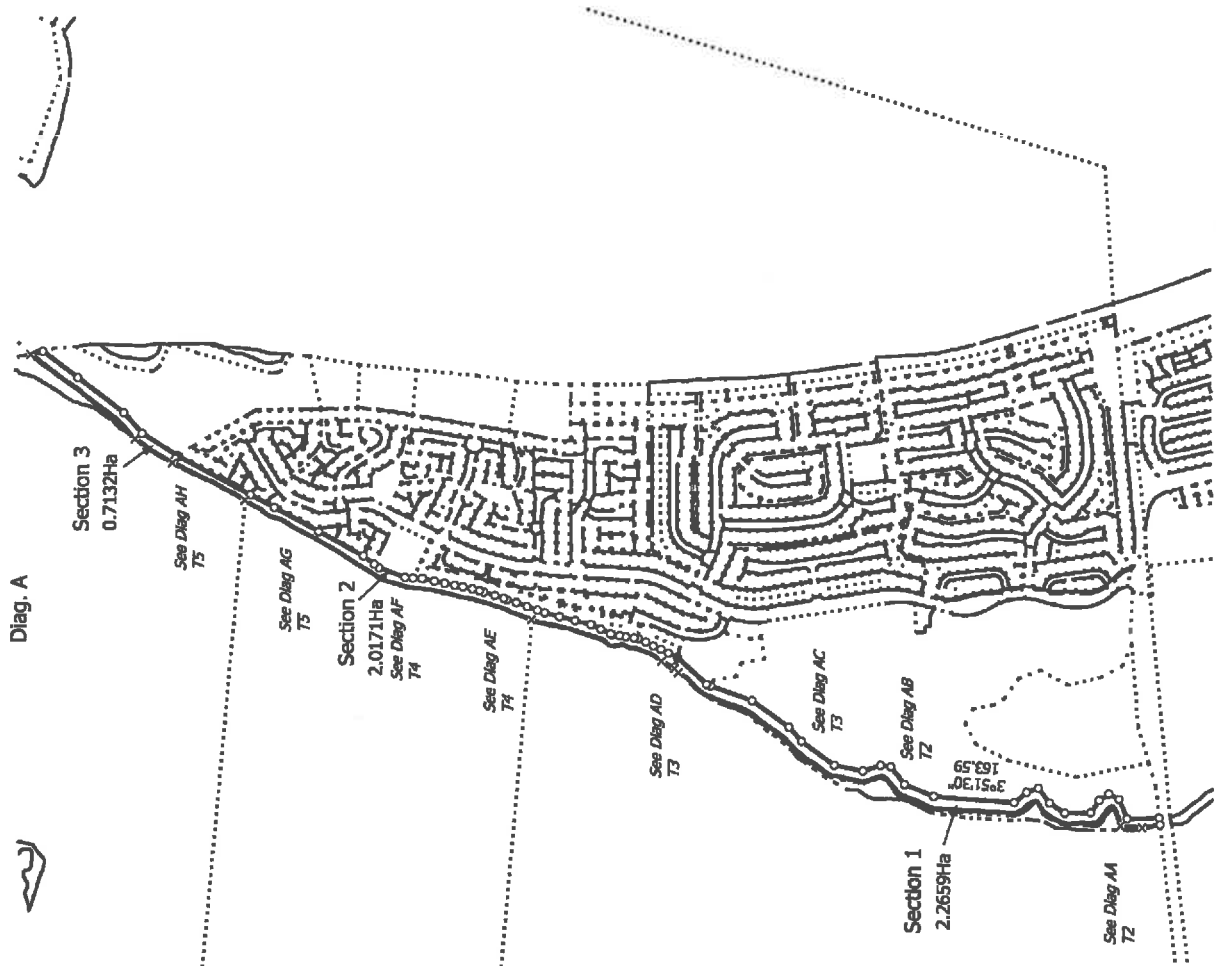

T 1/6

Title Plan
SO 524772
Approved on: 4/07/2018

Surveyor: Ian Derek Walker
Firm: Ascension Surveyors Ltd

Sections 1 to 3

Land District: North Auckland

Digitally Generated Plan
Generated on: 04/07/2018 10:35am Page 2 of 7



Diag. AB

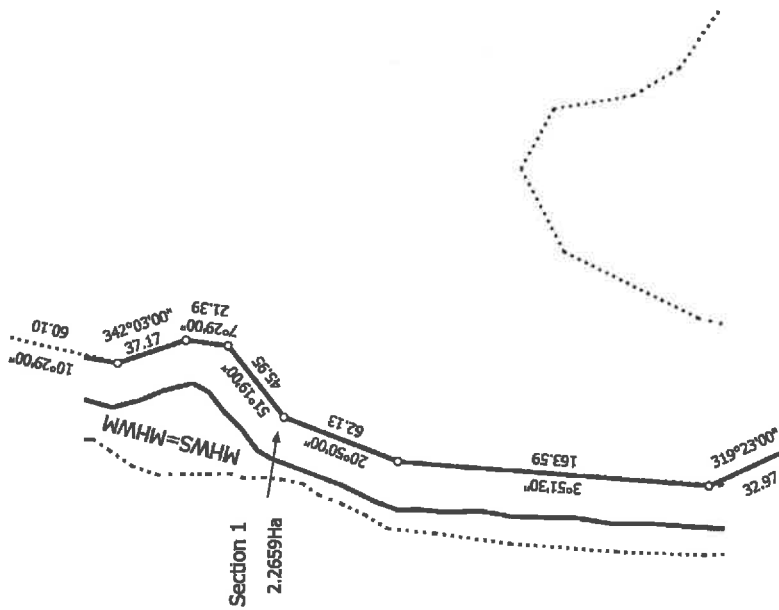

Diag. AA

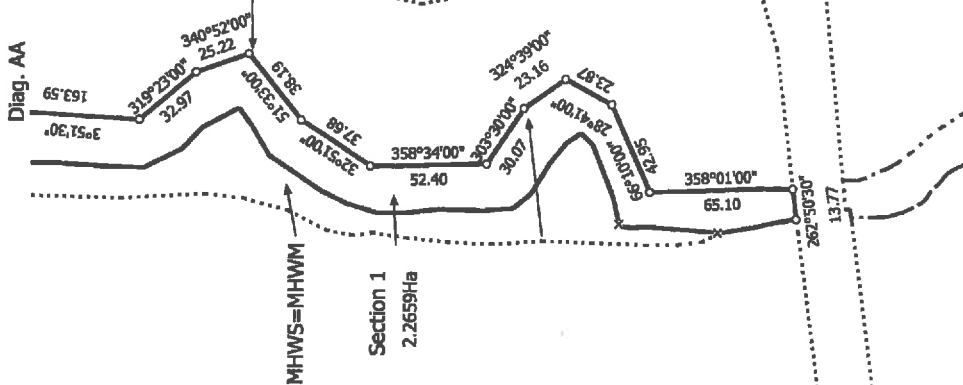

T 2/6

Title Plan
SO 524772
Approved on: 4/07/2018

Surveyor: Ian Derek Walker
Firm: Ascension Surveyors Ltd

Sections 1 to 3

Land District: North Auckland
Digitally Generated Plan
Generated on: 04/07/2018 10:35am Page 3 of 7



Diag. AC

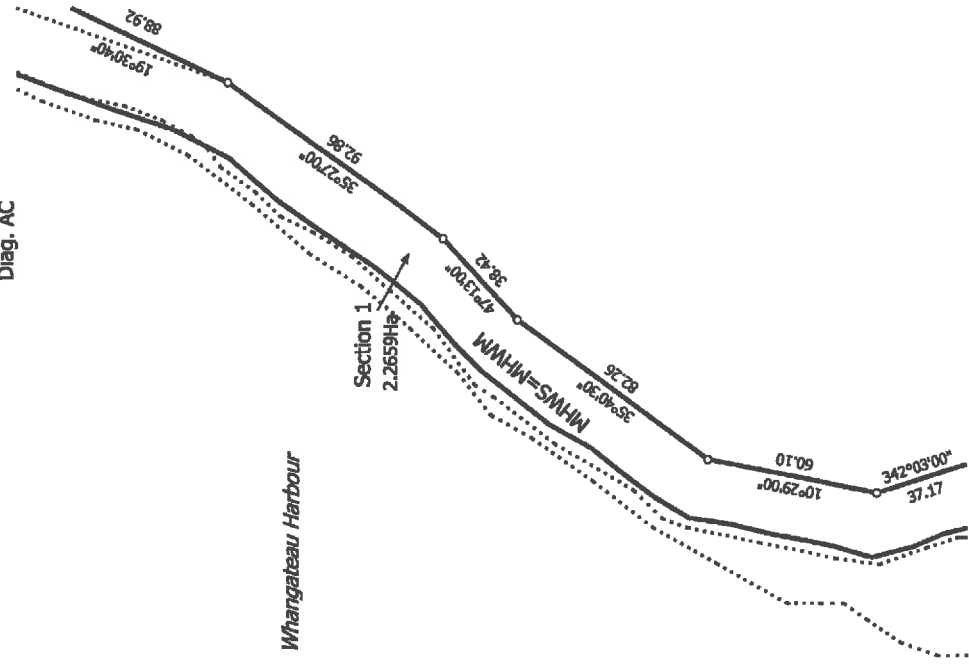

Whangateau Harbour

Section 1
2.2659Ha

Diag. AD

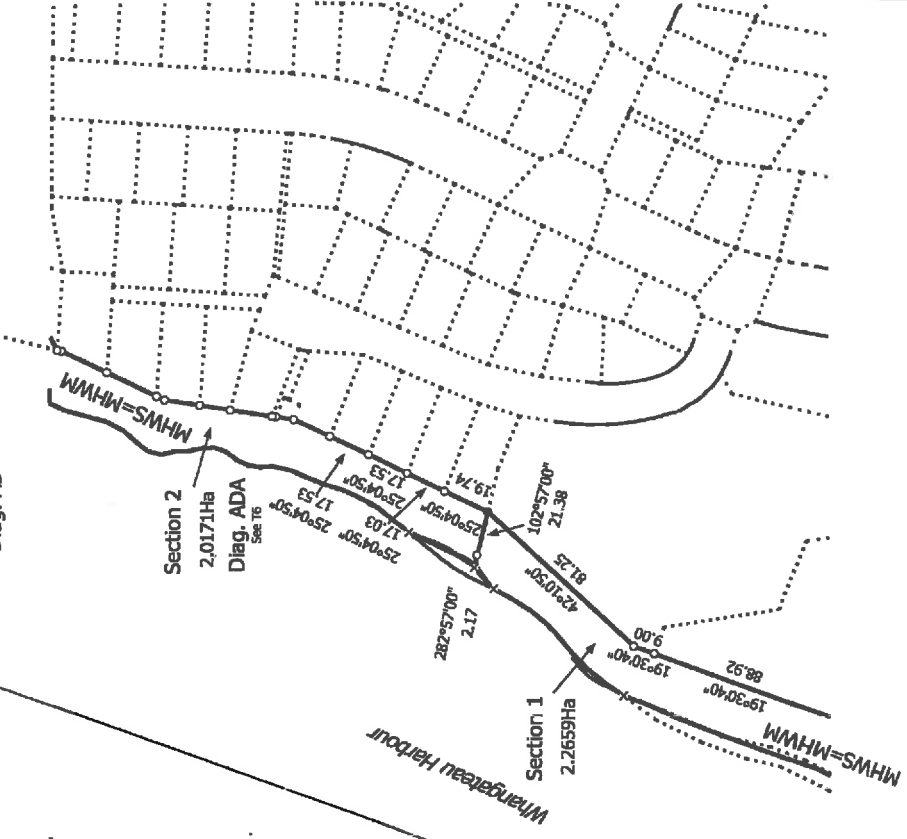

Whangateau Harbour

Section 2
2.0171Ha

Section 1
2.2659Ha

Diag. ADA
See 16

T 3/6

Sections 1 to 3

Surveyor: Ian Derek Walker
Firm: Ascension Surveyors Ltd

Title Plan
SO 524772
Approved on: 4/07/2018

Land District: North Auckland

Digitally Generated Plan
Generated on: 04/07/2018 10:35am Page 4 of 7



Sections 1 to 3





MHWS=MHW

Diag. AH

Whangateau Harbour

Section 3
0.7132Ha

Section 2
2.0171Ha

Diag. AG

MHWS=MHW

Whangateau Harbour

Section 2
2.0171Ha

T 5/6

Title Plan
SO 524772
Approved on: 4/07/2018

Surveyor: Ian Derek Walker
Firm: Ascension Surveyors Ltd

Sections 1 to 3

Land District: North Auckland

Digitally Generated Plan
Generated on: 04/07/2018 10:35am Page 6 of 7



Diag. ADA



T 8/6

Title Plan
SO 524772
Approved on: 4/07/2018

Surveyor: Ian Derek Walker
Firm: Ascension Surveyors Ltd

Sections 1 to 3

Land District: North Auckland

Digitally Generated Plan
Generated on: 04/07/2018 10:36am Page 7 of 7