

Attachment A

Licence to Occupy School Site Agreement

Clause 9.2(a) of the Licence to Occupy School Site states:

“The consent [for TAPAC to construct a building] does not expressly or impliedly grant any interest (legal or equitable) in the Licensed Area or the Centre, which will at all times remain in the ownership of the Crown”.

Pursuant to Clause 6.2, TAPAC is to pay all costs associated with the use and operation of the Centre including repairs and maintenance, insurance, rates and utilities.

TAPAC is also obliged to keep the Centre in good, clean, safe working order (Clause 8.1) taking into account factors such as the condition of the Centre when construction of it was completed, and fair wear and tear (Clause 8.2).

A JPH 120401 05 ISSUE
 B JPH 172401 RESOURCE CONSENT ISSUE
 C JPH 041702 CONSULTANTS ISSUE
 D JPH 021002 CONSULTANTS ISSUE
 E JPH 020702 JOX ISSUE
 F JPH 022202 80X ISSUE
 G JPH 031307 80X ISSUE

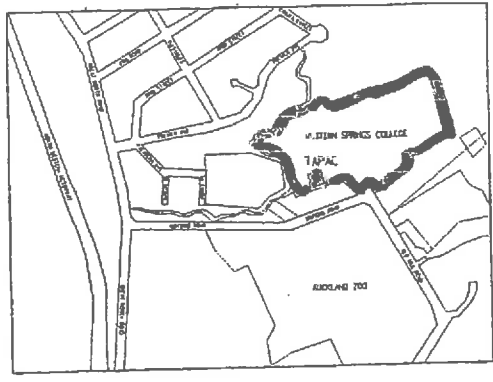

LOCATION PLAN n.t.s.

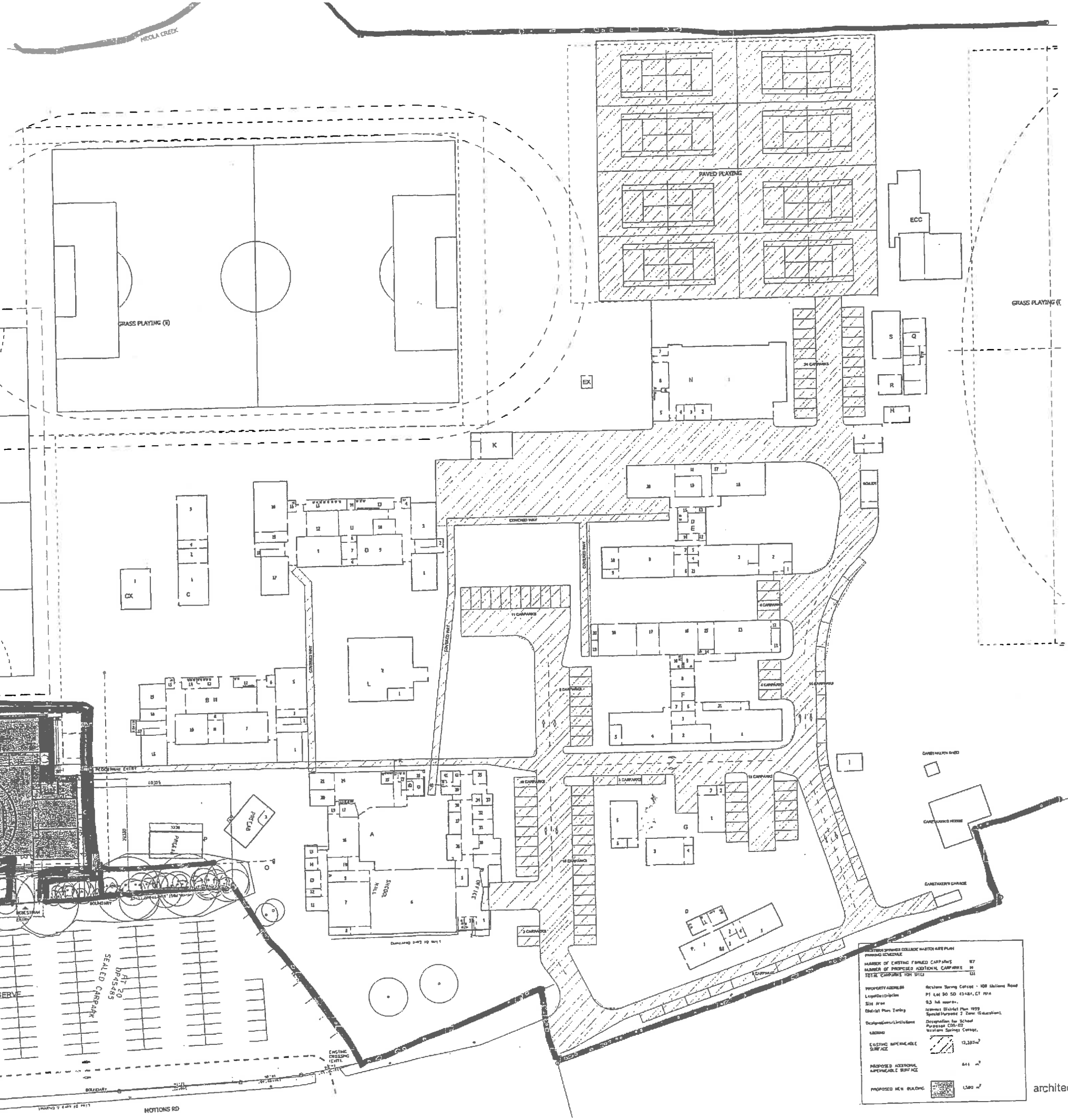

- CONSULTANTS
- ARCHITECT: WARREN & MAHONEY
 - LANDSCAPE ARCHITECT: MALTBYE
 - STRUCTURAL ENGINEER: Meritec
 - MECHANICAL/ELECTRICAL ENGINEER: Meritec
 - ACUSTIC CONSULTANT: MERIBALL DUFF ASSOCIATES
 - THEATRE CONSULTANTS: THEATRE ADVISORY SERVICES
 - SCULPTURE & ARTWORK CONSULTANT: LAUREN CLARKE
- CLIENT

The Auckland Performing Arts Centre
 @ WESTERN SPRINGS

SITE LOCALITY PLAN

THE OFFICE OF THE CHIEF ENGINEER WITH ARCHITECTURAL NAME & ADDRESS

SCALE @ A1	1:500
DATE	AUGUST 2001
JOB No	3947
DESIGNER	WARREN & MAHONEY
CLIENT	AUCKLAND COUNCIL
PROJECT	AUCKLAND WELLINGTON CHRISTCHURCH
PROJECT ADDRESS	Western Springs Centre - 100 Helens Road
LEGAL DESCRIPTION	P1 Lot 90 SD 42-184, CT 10A
SITE AREA	9.5 ha approx.
DESIGN PLAN TITLE	Resource Consent Plan 1999 Special Purpose 2 Zone (Education)
DESIGNER'S/CLIENT'S DESIGNATION	Designation for School Purpose Zone
ADDRESS	Western Springs Centre
EXISTING IMPERVIOUS SURFACE	13,300 m ²
PROPOSED ADDITIONAL IMPERVIOUS SURFACE	841 m ²
PROPOSED NEW BUILDING	1,500 m ²

architecture Warren and Mahoney