

Attachment 1: Approval for extension of the existing road name 'Puaki Drive' for Stage 2 of the Wiri North Quarry development

The Local Board Resolution number MR/2017/230 below:

21 New Road Name Approval for a short section of unnamed road located between 160 Roscommon Road and 149 Wiri Station Road, Manurewa (opposite Vogler Drive)

Resolution number MR/2017/230

MOVED by Deputy Chairperson R McLean, seconded by Member A Cunningham-Marino:

That the Manurewa Local Board, pursuant to section 319(1)(j) of the Local Government Act 1974:

- a) approve the road name 'Puaki Drive', proposed by the applicant, for the new road created by way of an upgrade to the intersection of Roscommon Road with Vogler Drive, Manurewa.

CARRIED

For reference, the extension of Puaki Drive (Lot 201) is illustrated below:

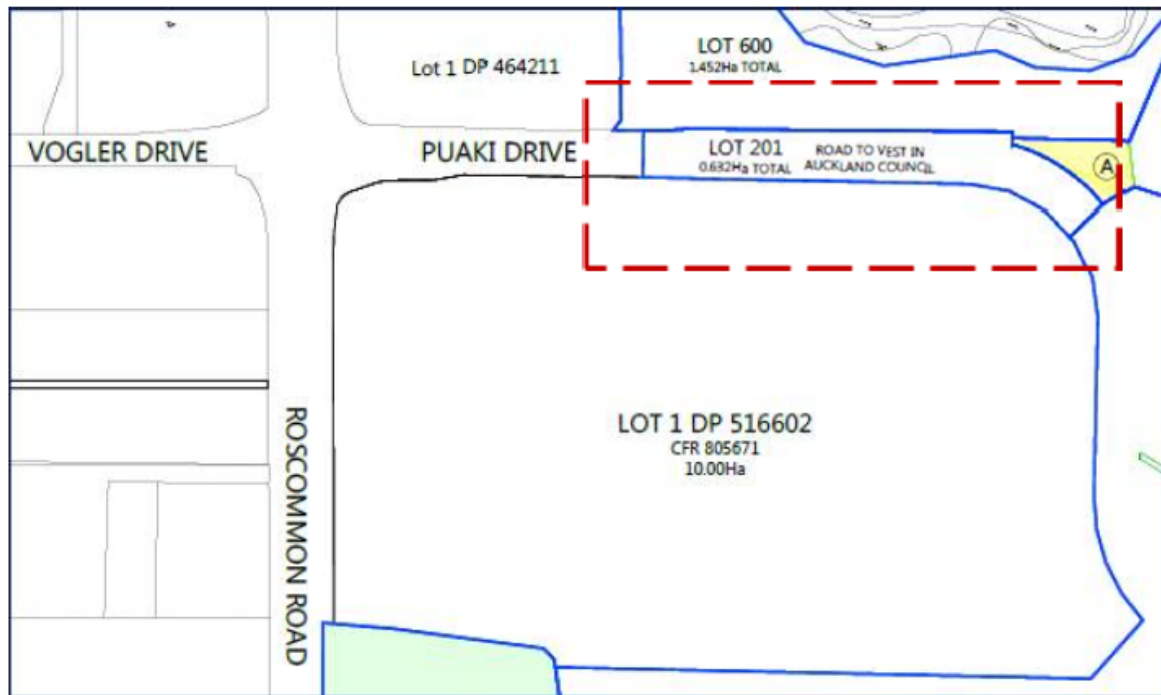

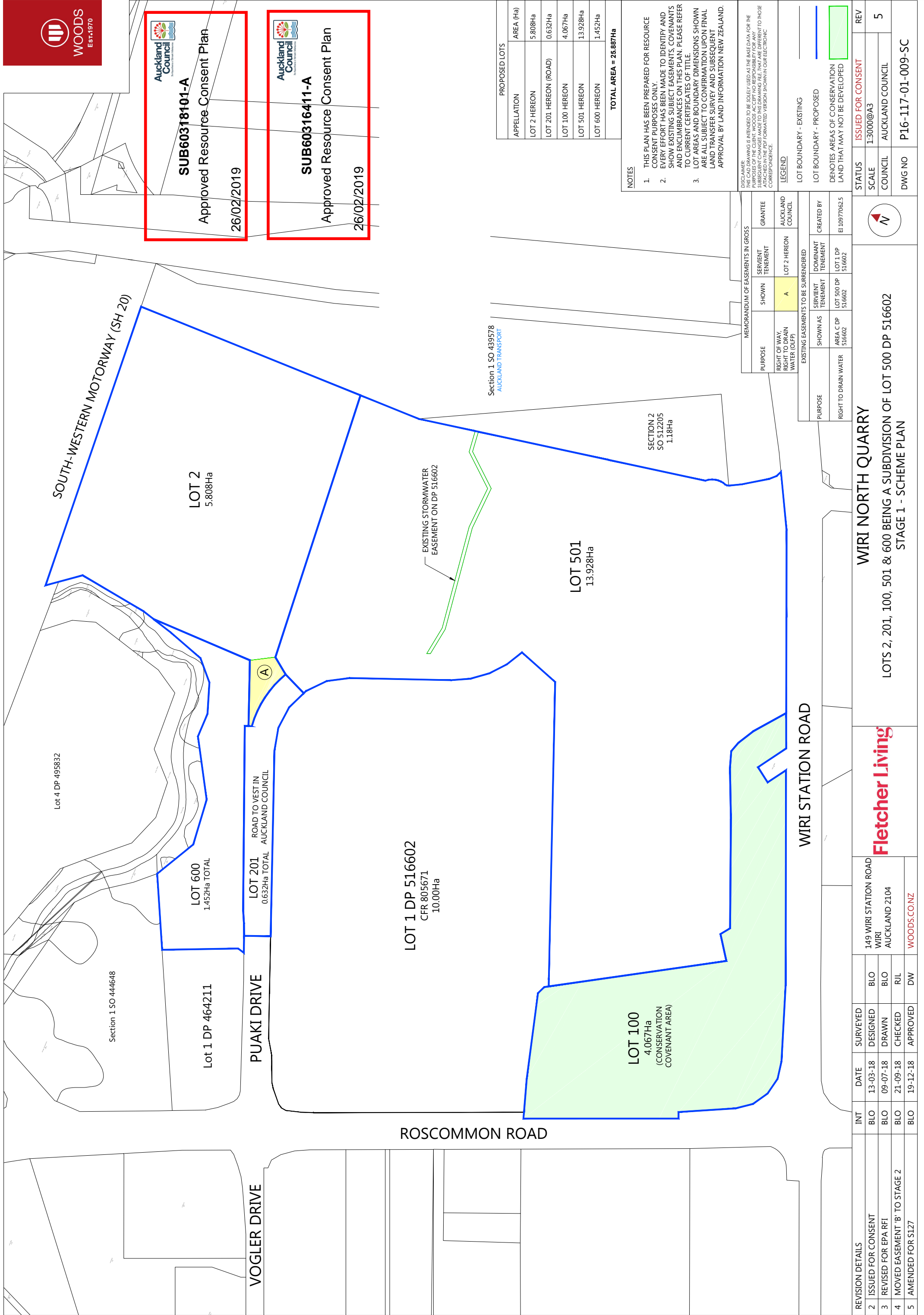

Auckland Council
SUB60318101-A
 Approved Resource Consent Plan
 26/02/2019

Auckland Council
SUB60316411-A
 Approved Resource Consent Plan
 26/02/2019

APPELLATION	AREA (Ha)
LOT 2 HEREON	5.808Ha
LOT 201 HEREON (ROAD)	0.632Ha
LOT 100 HEREON	4.067Ha
LOT 501 HEREON	13.928Ha
LOT 600 HEREON	1.452Ha
TOTAL AREA =	25.887Ha

NOTES

- THIS PLAN HAS BEEN PREPARED FOR RESOURCE CONSENT PURPOSES ONLY.
- EVERY EFFORT HAS BEEN MADE TO IDENTIFY AND SHOW EXISTING SUBJECT EASEMENTS, COVENANTS AND ENCUMBRANCES ON THIS PLAN. PLEASE REFER TO CURRENT CERTIFICATES OF TITLE.
- LOT AREAS AND BOUNDARY DIMENSIONS SHOWN ARE ALL SUBJECT TO CONFIRMATION UPON FINAL LAND TRANSFER SURVEY AND SUBSEQUENT APPROVAL BY LAND INFORMATION NEW ZEALAND.

DISCLAIMER:
 THIS CAD DRAWING IS INTENDED TO BE SOLELY USED AS THE BASE DATA FOR THE PREPARATION OF RESOURCE CONSENTS. ANY CHANGES MADE TO THIS DRAWING FILE THAT ARE DIFFERENT TO THOSE ATTACHED IN THE PDF FORMATTED VERSION SHOWN IN OUR ELECTRONIC CORRESPONDENCE.

LEGEND

LOT BOUNDARY - EXISTING

LOT BOUNDARY - PROPOSED

DENOTES AREAS OF CONSERVATION LAND THAT MAY NOT BE DEVELOPED

STATUS	ISSUED FOR CONSENT	REV
SCALE	1:3000@A3	5
COUNCIL	AUCKLAND COUNCIL	
DWG NO	P16-117-01-009-SC	

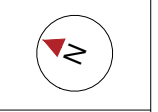

WIRI NORTH QUARRY
 LOTS 2, 201, 100, 501 & 600 BEING A SUBDIVISION OF LOT 500 DP 516602
 STAGE 1 - SCHEME PLAN

Fletcher Living

149 WIRI STATION ROAD
 WIRI
 AUCKLAND 2104
WOODS.CO.NZ

INT	DATE	SURVEYED	BLO
BLO	13-03-18	DESIGNED	BLO
BLO	09-07-18	DRAWN	BLO
BLO	21-09-18	CHECKED	RJL
BLO	19-12-18	APPROVED	DW

REVISION DETAILS	DATE	SURVEYED	BLO
2 ISSUED FOR CONSENT			BLO
3 REVISED FOR EPA RFI			BLO
4 MOVED EASEMENT 'B' TO STAGE 2			RJL
5 AMENDED FOR S127			DW