

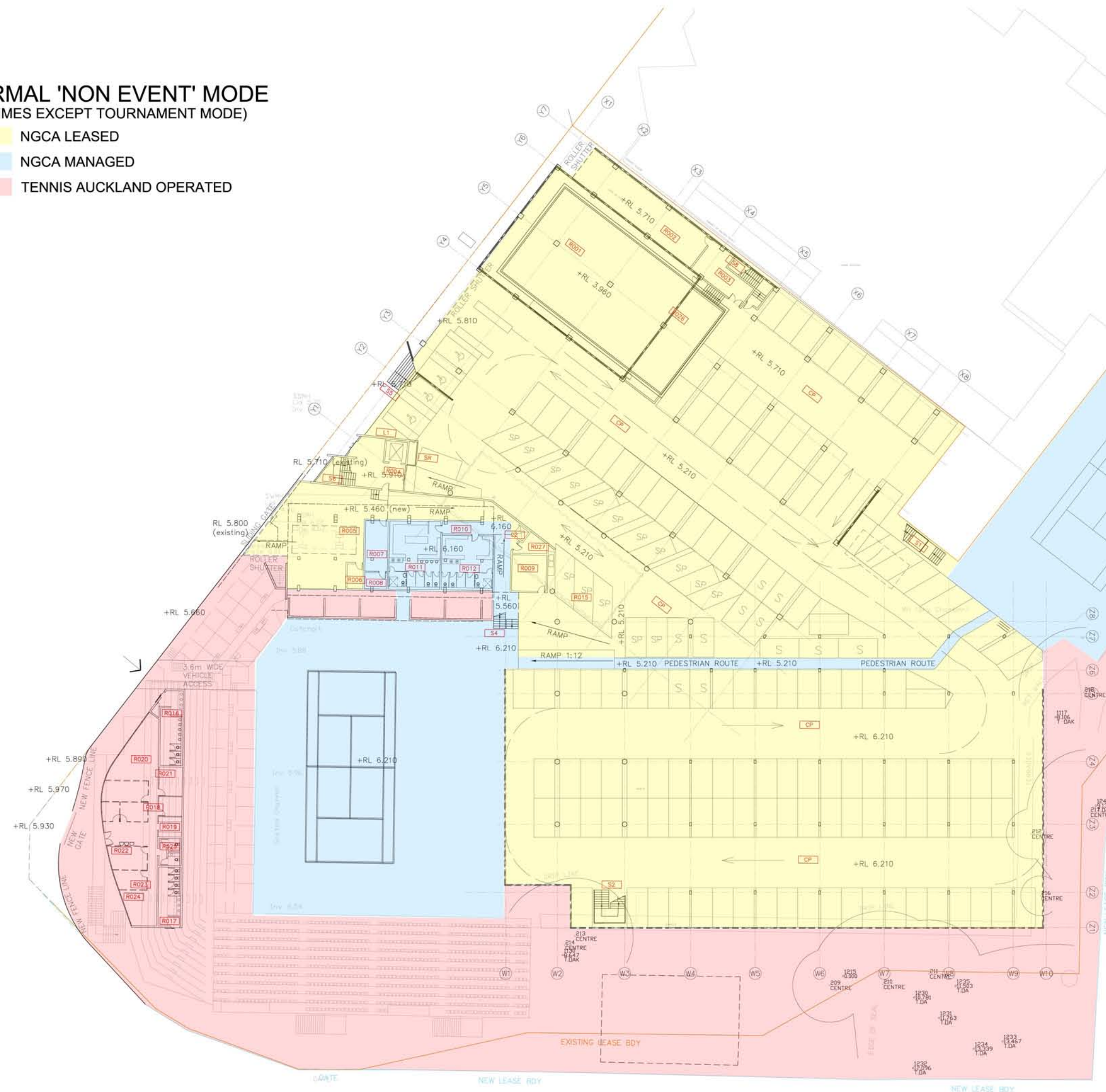

NOT FINAL

NORMAL 'NON EVENT' MODE
(ALL TIMES EXCEPT TOURNAMENT MODE)

- NGCA LEASED
- NGCA MANAGED
- TENNIS AUCKLAND OPERATED



code	room name	area (m ²)
LG - GROUND FLOOR		
R001	Pool Plant Room	220.0
R002	Plant Store	37.7
R003	Store	28.4
R004	Stair / Lift Lobby	35.0
R005	Loading Bay	170.0
R006	Office / Stock Control	6.1
R007	Staff Lounge	17.7
R008	Staff WC	5.6
R009	Staff-Change Office - General	21.0
R010	Corridor	9.4
R011	Public Changing Room - Male	54.1
R012	Public Changing Room - Female	40.3
R013	Accessible WC-Shower	5.0
R014	Accessible WC-Shower	5.0
R015	Catering Area	45.0
R016	Public WC - Male	25.6
R017	Public WC - Female	20.5
R018	Reception / Office (AT)	69.3
R019	Kitchen (AT)	4.8
R020	CEO Office (AT)	21.3
R021	Secretary Office (AT)	13.3
R022	Coaches Office (AT)	11.8
R023	Marketing Managers Office (AT)	8.0
R024	Meeting Room (AT)	16.4
R025	Staff WC (AT)	8.8
R026	Maintenance Workshop	42.6
R027	Tennis Pro Office	7.6

VERTICAL CORE		
S1	Stair 1	84.6
S2	Stair 2	95.1
S3	Stair-3	40.2
S4	Stair 4	15.5
S5	Stair 5	49.0
S6	Stair 6	45.1
S7	Stair 7	32.0
S8	Stair 8	12.8
L1	Lift 1	6.0
L2	Lift 2	TBC
SR	Service Riser	3.3
PT	Plant Tower	20.2

OTHER		
CP	Car Park	4486.0



NORMAL 'NON EVENT' MODE
(ALL TIMES EXCEPT TOURNAMENT MODE)

- NGCA LEASED
- NGCA MANAGED
- TENNIS AUCKLAND OPERATED

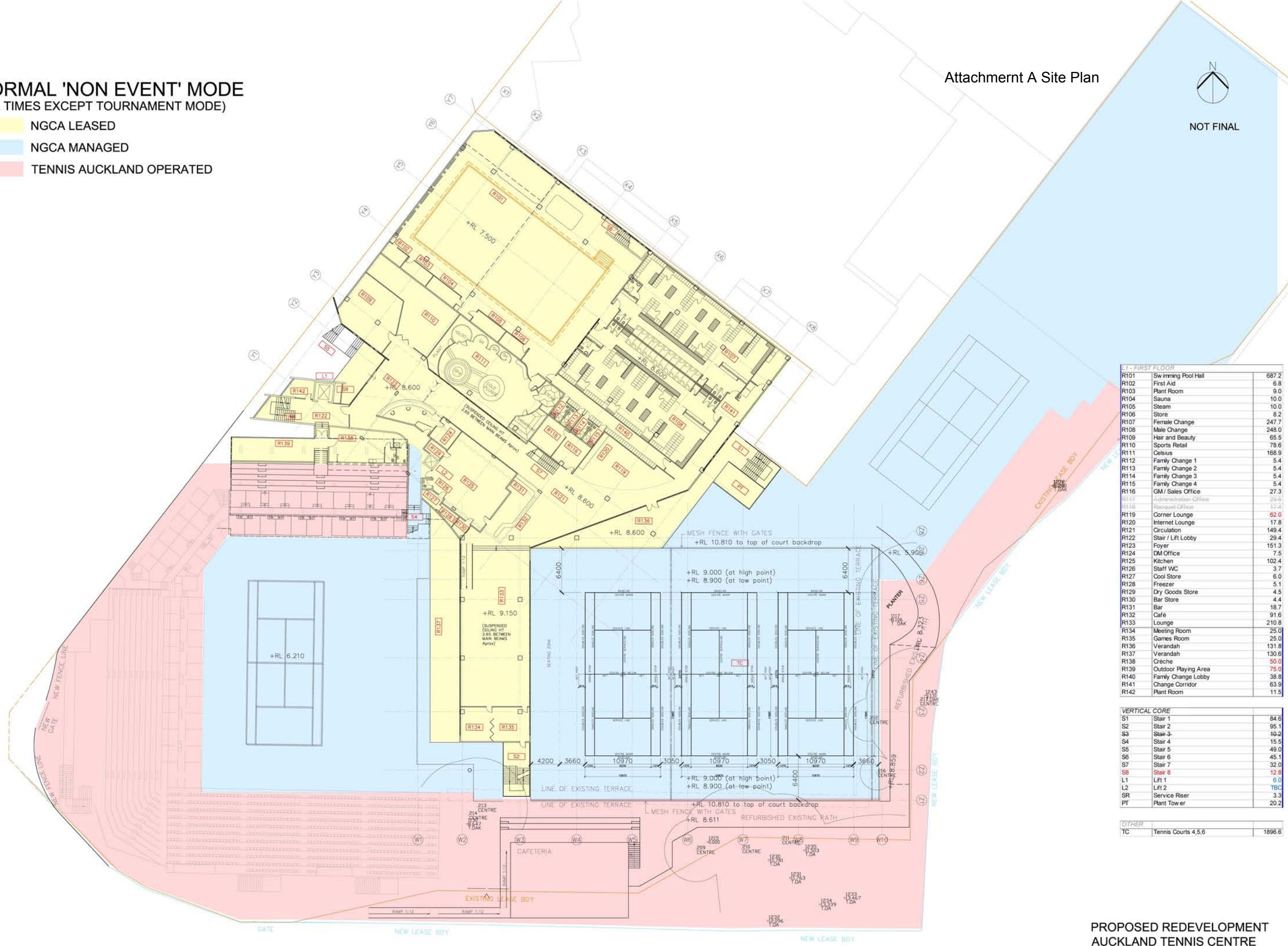

L1 - FIRST FLOOR

R101	Swimming Pool Hall	687.2
R102	First Aid	6.8
R103	Plant Room	9.0
R104	Sauna	10.0
R105	Steam	10.0
R106	Store	8.2
R107	Female Change	247.7
R108	Male Change	248.0
R109	Hair and Beauty	65.5
R110	Sports Retail	78.6
R111	Celsius	168.9
R112	Family Change 1	5.4
R113	Family Change 2	5.4
R114	Family Change 3	5.4
R115	Family Change 4	5.4
R116	GM / Sales Office	27.3
R117	Administration Office	29.8
R118	Reception Office	17.4
R119	Corner Lounge	62.0
R120	Internet Lounge	17.8
R121	Circulation	149.4
R122	Stair / Lift Lobby	29.4
R123	Foyer	151.3
R124	DM Office	7.5
R125	Kitchen	102.4
R126	Staff WC	3.7
R127	Cool Store	6.0
R128	Freezer	5.1
R129	Dry Goods Store	4.5
R130	Bar Store	4.4
R131	Bar	18.7
R132	Café	91.6
R133	Lounge	210.8
R134	Meeting Room	25.0
R135	Games Room	25.0
R136	Verandah	131.8
R137	Verandah	130.6
R138	Crèche	50.0
R139	Outdoor Playing Area	75.0
R140	Family Change Lobby	38.8
R141	Change Corridor	63.9
R142	Plant Room	11.5

VERTICAL CORE

S1	Stair 1	84.6
S2	Stair 2	95.1
S3	Stair 3	40.2
S4	Stair 4	15.5
S5	Stair 5	49.0
S6	Stair 6	45.1
S7	Stair 7	32.0
S8	Stair 8	12.8
L1	Lift 1	6.0
L2	Lift 2	TBC
SR	Service Riser	3.3
PT	Plant Tower	20.2

OTHER

TC	Tennis Courts 4, 5, 6	1896.6
----	-----------------------	--------



NOT FINAL

NORMAL 'NON EVENT' MODE
(ALL TIMES EXCEPT TOURNAMENT MODE)

- NGCA LEASED
- NGCA MANAGED
- TENNIS AUCLAND OPERATED

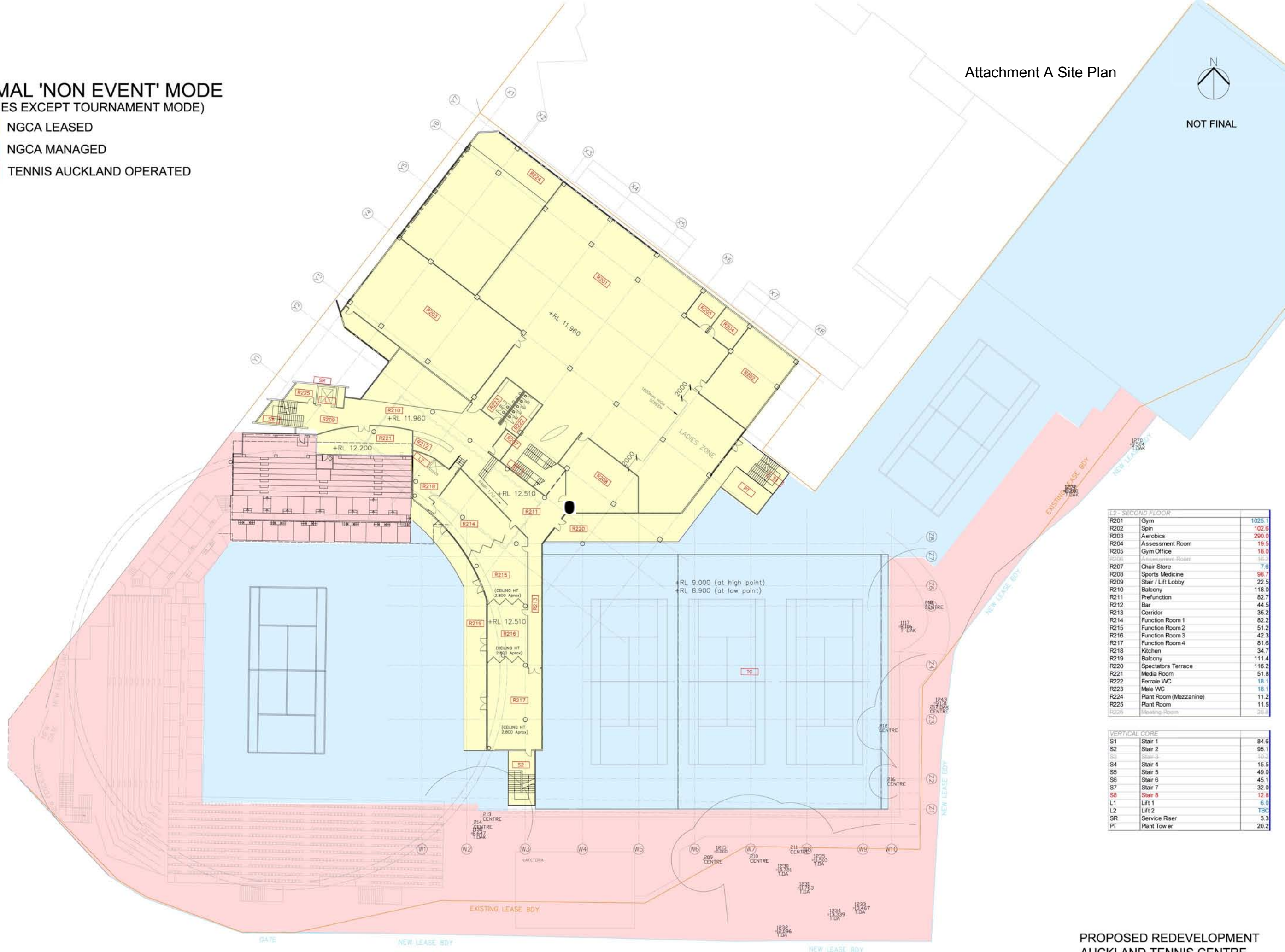

L2 - SECOND FLOOR		
R201	Gym	1025.1
R202	Spin	102.6
R203	Aerobics	290.0
R204	Assessment Room	19.5
R205	Gym Office	18.0
R206	Assessment Room	16.2
R207	Chair Store	7.6
R208	Sports Medicine	98.7
R209	Stair / Lift Lobby	22.5
R210	Balcony	118.0
R211	Prefunction	82.7
R212	Bar	44.5
R213	Corridor	35.2
R214	Function Room 1	82.2
R215	Function Room 2	51.2
R216	Function Room 3	42.3
R217	Function Room 4	81.6
R218	Kitchen	34.7
R219	Balcony	111.4
R220	Spectators Terrace	116.2
R221	Media Room	51.8
R222	Female WC	18.1
R223	Male WC	18.1
R224	Plant Room (Mezzanine)	11.2
R225	Plant Room	11.5
R226	Meeting Room	25.8

VERTICAL CORE		
S1	Stair 1	84.6
S2	Stair 2	95.1
S3	Stair 3	10.1
S4	Stair 4	15.5
S5	Stair 5	49.0
S6	Stair 6	45.1
S7	Stair 7	32.0
S8	Stair 8	12.8
L1	Lift 1	6.0
L2	Lift 2	TBC
SR	Service Riser	3.3
PT	Plant Tower	20.2



NOT FINAL

NORMAL 'NON EVENT' MODE
(ALL TIMES EXCEPT TOURNAMENT MODE)

- NGCA LEASED
- NGCA MANAGED
- TENNIS AUCKLAND OPERATED

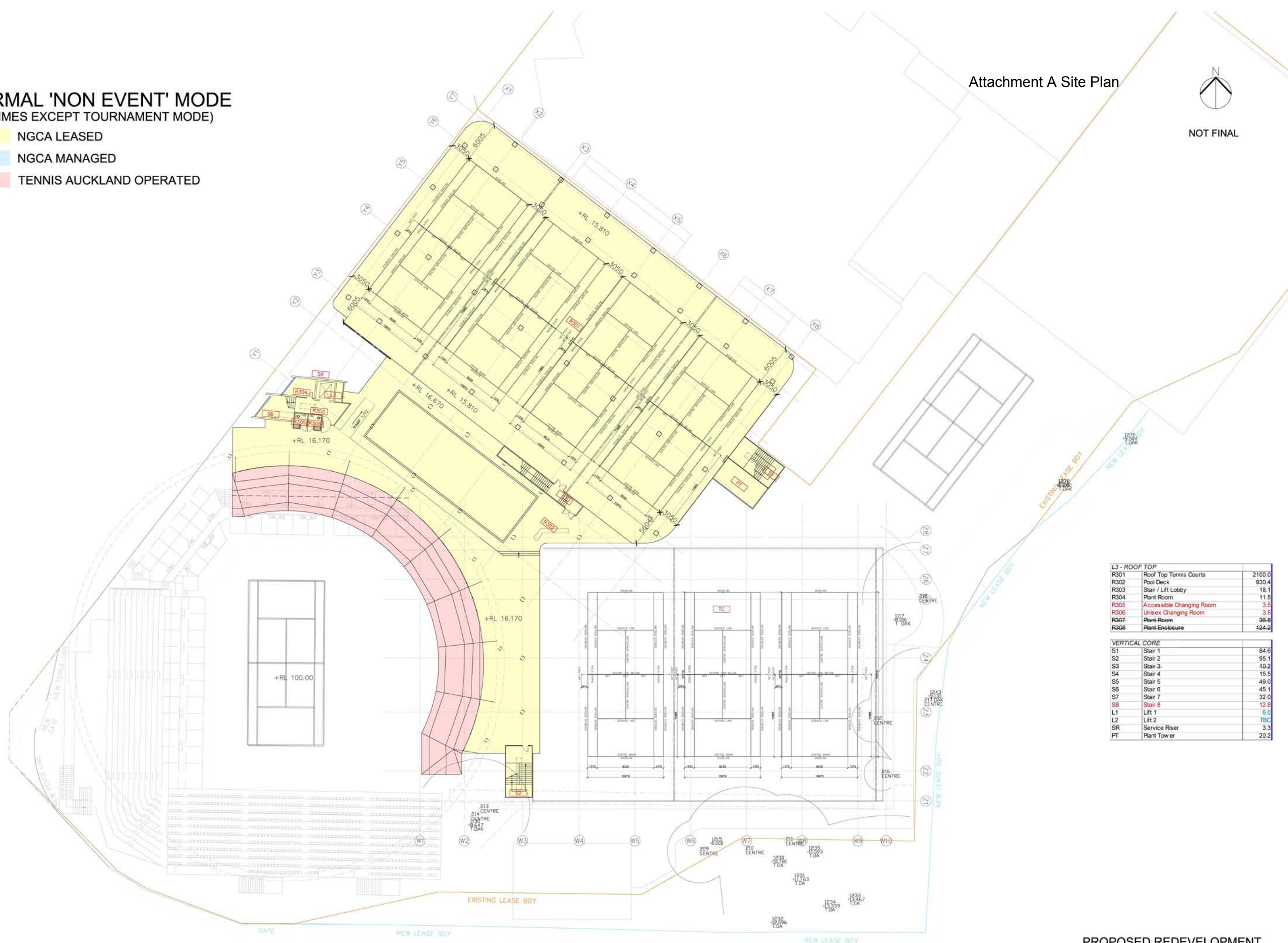

L3 - ROOF TOP		
R301	Roof Top Tennis Courts	2100.0
R302	Pool Deck	930.4
R303	Stair / Lift Lobby	18.1
R304	Plant Room	11.5
R305	Accessible Changing Room	3.5
R306	Unisex Changing Room	3.5
R307	Plant Room	36.8
R308	Plant Enclosure	124.2

VERTICAL CORE		
S1	Stair 1	84.6
S2	Stair 2	95.1
S3	Stair 3	40.2
S4	Stair 4	15.5
S5	Stair 5	49.0
S6	Stair 6	45.1
S7	Stair 7	32.0
S8	Stair 8	12.8
L1	Lift 1	6.0
L2	Lift 2	TBC
SR	Service Riser	3.3
PT	Plant Tower	20.2