

Attachment B:

Scheme Plan of Subdivision for 185 Jutland Road, Pukekohe showing the portion of Lot 100 to be given a new name outlined in red. The other portion of Lot 100 (outlined in blue) will be a through road and be a continuation of Whakapono Road from the south (see road linkage plan below and Belmont Structure Plan Attachment A above).

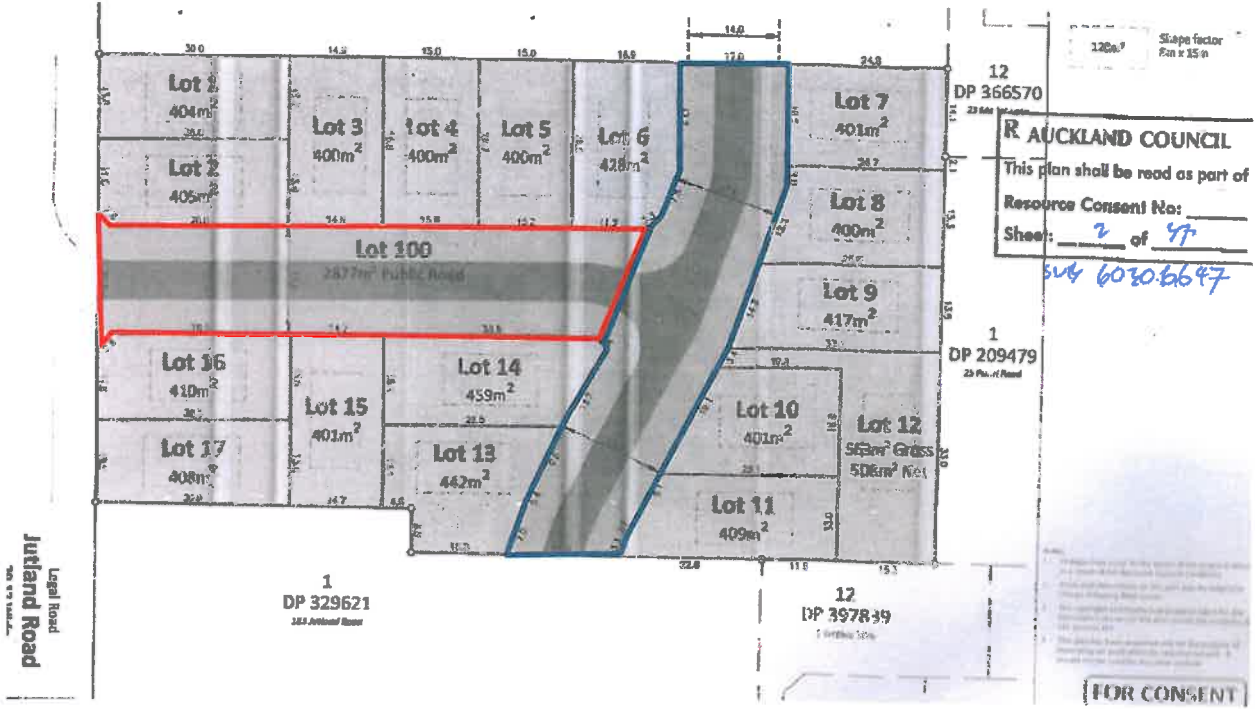

Road linkage plan

New road name intended for Road 1. Proposed Road 2 will continue Whakapono Road name from south (created by subdivision of 175 Jutland Road – see below).

