

Date: Wednesday, 7 May 2025
Time: 11:00am
Meeting Room: Local Board Chambers
Venue: 35 Coles Crescent
Papakura
Auckland

Papakura Local Board Workshop

OPEN AGENDA

MEMBERSHIP

Chairperson Brent Catchpole
Deputy Chairperson Jan Robinson
Members Felicity Auva'a
George Hawkins
Kelvin Hieatt
Andrew Webster

Sital Prasad
Democracy Advisor

2 May 2025

Contact Telephone: 273255719
Email: sital.prasad@aucklandcouncil.govt.nz
Website: www.aucklandcouncil.govt.nz

ITEM	TABLE OF CONTENTS	PAGE
1	Ngā Tamōtanga Apologies	2
2	Te Whakapuaki i te Whai Pānga Declaration of Interest	2
3	Local Board Workshop	3

Agenda items

1 Ngā Tamōtanga | Apologies

At the close of the agenda no apologies had been received.

2 Te Whakapuaki i te Whai Pānga | Declaration of Interest

Members are reminded of the need to be vigilant to stand aside from decision making when a conflict arises between their role as a member and any private or other external interest they might have.

Local Board Workshop

File No.: CP2025/08272

Note 1: This workshop has been called by the chairperson in consultation with the staff.

Note 2: No working party/workshop may reach any decision or adopt any resolution unless specifically delegated to do so.

Te take mō te pūrongo **Purpose of the report**

1. To present the Papakura Local Board workshop agenda for 7 May 2025.

Whakarāpopototanga matua **Executive summary**

2. Most workshops are open to the public to attend as observers in person or online, if in person attendance is impractical.
3. Some sessions may not be open to the public. The chairperson and deputy chairperson decide which sessions are open to the public, depending on the sensitivity of the information being discussed. If a session is not open, a reason will be provided below.
4. Local Board workshops provide an opportunity for local boards to carry out their governance role in the following areas:
 - a) accountability to the public
 - b) engagement
 - c) input to regional decision-making
 - d) keeping informed
 - e) local initiative / preparing for specific decisions
 - f) oversight and monitoring
 - g) setting direction / priorities / budget.
5. Workshops do not have decision-making authority.
6. Workshops are used to canvass issues, prepare local board members for upcoming decisions and to enable discussion between elected members and staff.
7. Members are respectfully reminded of their Code of Conduct obligations with respect to conflicts of interest and confidentiality
8. Please note, workshop times are often subject to change.

Item 3

9. The following will be covered in the workshop:

Item 1 – 11:00-11:30am	
Infrastructure and Environmental Services 2024/2025 Quarter three update	
Presenter/s:	<p>Kartik Bhart (Relationship Advisor, Relationship Advisory)</p> <p>Courtenay Hunt (Senior Community Advisor, Waste Solutions)</p>
Governance role:	Oversight and monitoring
Proposed Outcome/s:	To provide the 2024/2025 Infrastructure and Environmental Services work programme quarter three update.
Attachment/s:	Attachment A – Item 1: Learning to Love our Planet - Sustainable Papakura
Item 2 – 11:30-12:00pm	
Southern Park - undertake investigation to develop a new car park	
Presenter/s:	<p>Ana Anufe (Project Manager)</p> <p>Alex Overwater-Davis (Manager Area Operations, Parks and Community Facilities)</p> <p>Manuel Raimundo (Work Programme Lead, Parks and Community Facilities)</p>
Governance role:	Setting direction / priorities / budget
Proposed Outcome/s:	To direction from the local board on the concept design and costing for the development of a new car park at Southern Park.
Attachment/s:	Attachment B – Item 2: Southern Park Options
Lunch Break (12:00–12.30pm)	
Item 3 – 12:30-1:15pm	
Draft Papakura Sport and Active Recreation Facilities Plan	
Presenter/s:	<p>Kieran Nevey (Sport & Recreation Lead)</p> <p>Barry George (Sport & Recreation Lead)</p> <p>Andy Adams (Consultant)</p>
Governance role:	Setting direction / priorities / budget

Proposed Outcome/s: To seek direction on the Draft Papakura Sport and Active Recreation Facilities Plan, prior to formal adoption of the plan at the 28 May 2025 Papakura Local Board Business meeting.

Attachment/s: Attachment C – Item 3: Papakura Sport and Active Recreation Facilities Plan Memo

Attachment D – Item 3: V2. Draft Papakura Sport and Active Recreation Facilities Plan

Attachment E – Item 3: Papakura Sport and Active recreation Facilities Plan Presentation

Item 4 – 1:15-2:00pm

Pools and Leisure six monthly 2024/2025 performance update

Presenter/s: Garth Dawson
 (Head of Service Partner Delivery, Service Partner Delivery)

Governance role: Oversight and monitoring

Proposed Outcome/s: To keep the local board informed on the performance of the pools and leisure centres in the local board area in relation to the regional network.

Attachment/s: Attachment F – Item 4: Pools and Leisure Papakura operational updates

Break (2:00-2:10pm)

Item 5 – 2:10-2:40pm

Operational Shift: Proposed Transition of Smiths Ave to Community Centre Management Agreement (CCMA) Contract

Presenter/s: Dominic Lee
 Specialist Advisor, Community Delivery (South)

Jane Cain
 (Place & Partner Specialist, Community Delivery (South))

Governance role: Keeping informed

Proposed Outcome/s: To discuss the proposed operational shift for Smiths Ave to a Community Centre Management Agreement (CCMA) contract.

Attachment/s: Attachment G – Item 5: Final Smiths Ave - Proposed Operational Shift to CCMA Agreement

Item 5 – 2:40-3:40pm

Direction Setting

Presenter/s: Victoria Hutt
 (Papakura Local Board Senior Advisor, Governance & Engagement)

Governance role: Setting direction / priorities / budget

Proposed Outcome/s: To inform the board on upcoming events/meetings and seek board's feedback.

For members to provide strategic updates related to meetings/briefings they have attended, highlighting opportunities for board decision making or advocacy.

Attachment/s: Material unavailable at the time of agenda build.

Item 3

Ngā tāpirihanga Attachments

No.	Title	Page
A	Attachment A – Item 1: Learning to Love our Planet - Sustainable Papakura	7
B	Attachment B – Item 2: Southern Park Options	17
C	Attachment C – Item 3: Papakura Sport and Active Recreation Facilities Plan Memo	31
D	Attachment D – Item 3: V2. Draft Papakura Sport and Active Recreation Facilities Plan (<i>Under Separate Cover</i>)	
E	Attachment E – Item 3: Papakura Sport and Active recreation Facilities Plan Presentation	37
F	Attachment F – Item 4: Pools and Leisure Papakura operational updates	51
G	Attachment G – Item 5: Final Smiths Ave - Proposed Operational Shift to CCMA Agreement	71



Learning to Love our Planet

1/07/24-
30/04/25

Sustainable Living Skills Workshop Organisation and Delivery

12hrs a week

28 Kids workshops:

After school
Holidays

In school or community
Waste diverted- 45 kg

Themes:

- Upcycling items found at home or Base
- Recycling Right
- Reducing Waste
- Reusing
- Caring for Te Taiao



233 tamariki accompanied by 193 adults

Kids say:

'I made a soft plastics station for my house and my mum put it on the kitchen bench so we can all use it'.

Parents say:

'Teach children positive messages about waste and what they can do themselves to encourage our family to make better choices with waste'.

'Show us that we can recreate these activities at home using everyday materials that we would normally throw away'.



**Adult/ whānau
Sustainable Living
Workshops- 73
Waste diverted- 80kg**

'We had a great time learning from each other. The best way to learn is by sharing knowledge'.

'Home-made is better than store bought, with less waste'.

'The Base is a great space to have these workshops because there are so many resources that I can use'.

'The skills I am learning during these workshops allow me to get longer use of clothing'.



Adults/ whānau Attendance: 713

'I look in op shops for material and recycled blankets to repurpose'.

'I think more sustainably'.

'I love the ideas about how I can repurpose items, so they have a new life and don't go to landfill'.

'I gained a lot of knowledge about how to use everyday items to make fantastic gifts to give away especially from items I would normally put in the rubbish'.



Promotions, 9 hours a week

- Producing Flyers and Posts to advertise and support Workshops and Events
- Producing ongoing Educational Series for Facebook
- Creating Promotional Material for all
- Sustainable Papakura projects
- Achievements: increase in workshop registrations to almost full enrollment levels

Ongoing Educational series e.g:



Working at the TOP of the Waste Hierarchy

At Sustainable Papakura we are changing the narrative:

'Let's have more focus on Re-thinking how we can avoid making waste. Make (energy intensive) recycling our last resort'

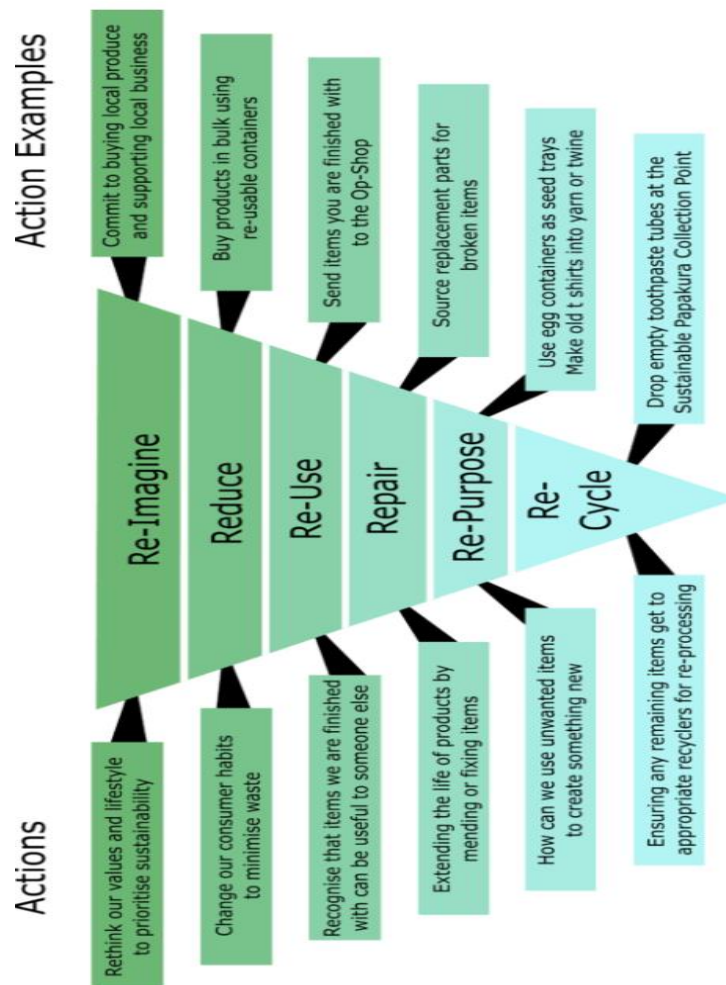

Challenges and Solutions to Engagement

Lack of Motivation

- Many people do not experience a sense of urgency to reimagine lifestyles or support a circular economy
- Many people do not associate ill-health, scarcity or cost of living issues with climate change or waste of resources

Tapping into Existing Motivation

Needs for feeling good and in control of their lives:

- Social Wellbeing
- Cost of living
- Personal Growth

Last words from workshop participants:

'I can't believe these workshops are put on for free and we get the wealth of knowledge from the facilitators and volunteers each time- thank you Local Board and Sustainable Papakura.'

- Social Wellbeing:

'Coming out each week has been the highlight of my week'.

'We donate items that can be used for the workshops, so we feel like we are contributing to making the workshops happen'.

- Cost of Living:

'I can now make small items to sell which will help me as we only have one income and a very tight budget'.

- Personal Growth:

'I'm able to talk to people a lot easier now and ask for help from people in the classes.'

'Learning that we have to give the first one we make away. It is a Māori kaupapa. We felt good about giving away our first crafts each week'.

'The volunteers are happy and supportive during the workshops for our kids'.

Southern Park - undertake investigation to develop a new car park

Papakura Local Board- 7 May 2025

Ana Anufe – Parks & Community Facilities Project Manager



Purpose and intended outcome

The purpose of this presentation is to outline various car parking concepts, provide indicative high-level cost estimates, and identify key constraints associated with each option.

The intended outcome is for the Papakura Local Board to select a preferred option and determine whether Auckland Council staff should proceed to the developed design phase.





Current setting



Scope

- Investigate existing utilities and park features to relation to developing a new car park
- Provide car park development options with high level costs
- Arboriculture assessment

In scope

- Any works relating to the existing fields
 - Lighting
- Existing changing room and ECE learning centre

Out of scope

Carpark location options (presented to the Board 9/10/2024)

Southern Park – carpark development

Location	Benefits	Disadvantages
Location 1	<ul style="list-style-type: none"> Enough space for pedestrian access on either the eastern or western boundary. Only 1 large tree is to be protected. 	<ul style="list-style-type: none"> Need a traffic assessment for new right turning traffic. Need to get driveway crossing approval from NZTA. Neighbours a newly built day care (#30 Beach Road) and residential on the other side. Will need a footpath to connect car park to the rugby fields
Location 2 (local board provided direction to proceed the I&D for option 2, shown in red)	<ul style="list-style-type: none"> Existing driveway that is wide enough to meet the turning requirement for a car park that has greater than 30 car parks. Also, no requirement for crossing approval from NZTA. Don't need to have a traffic assessment for new right turning traffic. Pedestrian access can easily be incorporated along the western boundary of the existing driveway. Cars can park and face the playing fields; this would be beneficial during rainy days. Closer to the changing rooms. 	<ul style="list-style-type: none"> 3 large trees to be protected. The turning area for the incoming traffic turning into the red polygon will need to be specific design.

For both locations:

- Specifically designed stormwater discharge is required if more than 30 car parks.
- Arborists needs to be involved regardless of the location.
- Resource consent is required regardless of location.



Development options at Location 2

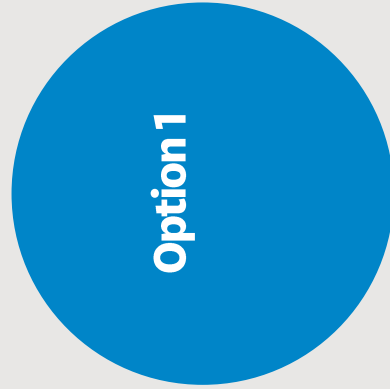

Option 1

- Provides total 22 carparks comprising 20 standard and 2 accessible
- **\$503,715.12**

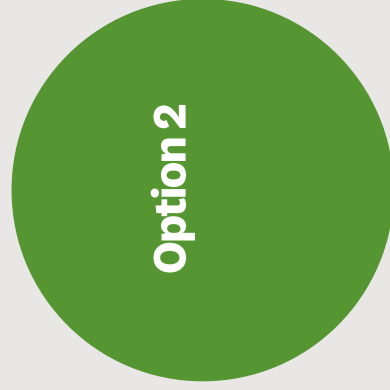

Option 2

- Provides total 29 car parks comprising 27 standard and 2 accessible
- **\$481,674.34**



Option 3

- Provides total 24 car parks comprising 22 standard and 2 accessible
- **\$564,242.77**

All estimates are high level only and include a 15% contingency.
Add \$50,000 to all estimates for consenting and consulting



Option 1

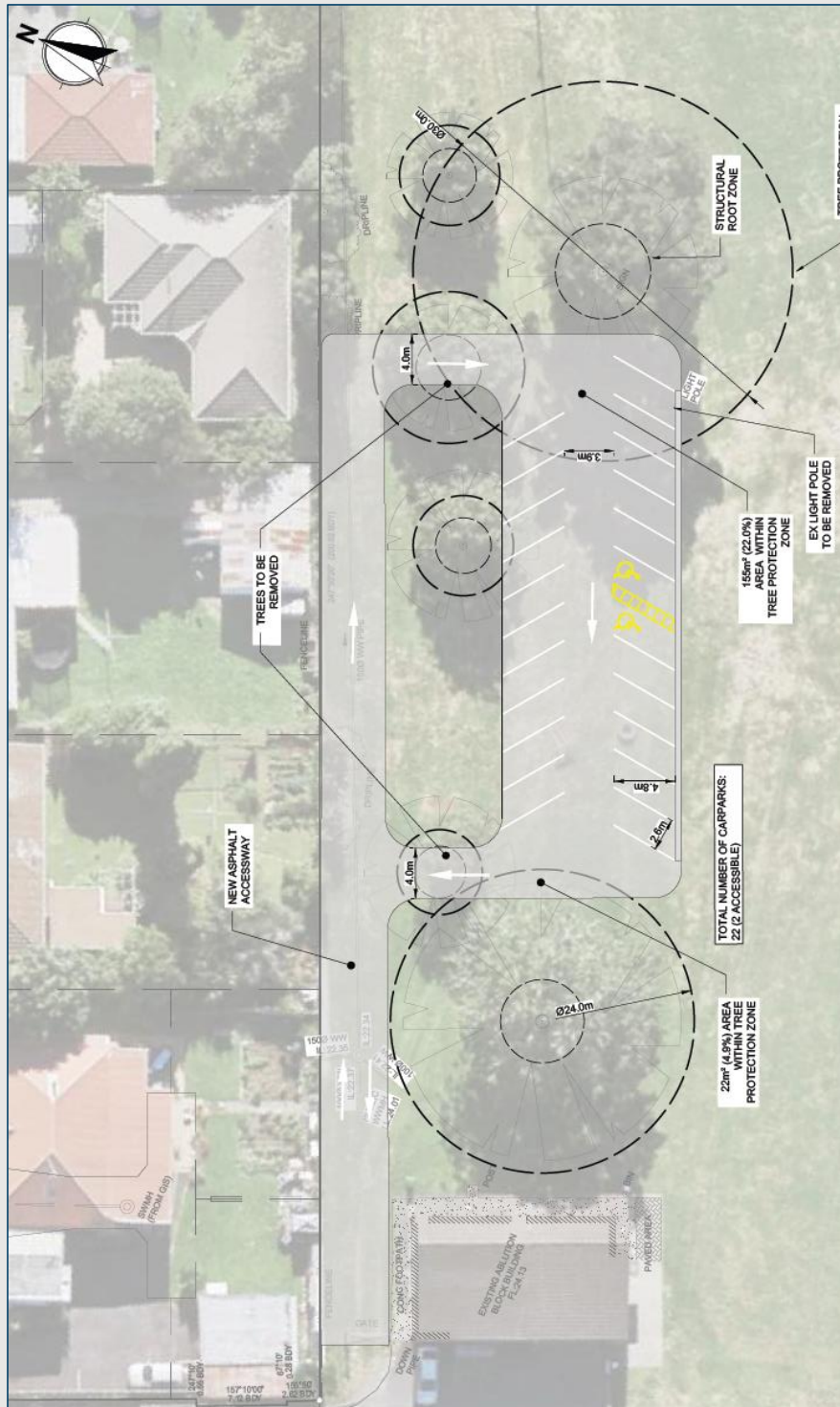

- TOA required for removal of 2 trees



Option 2

TOA required for
removal of 2 trees



Option 3



- No tree's removed



Constraints to consider

1. Existing utility services:
 - 150mm diameter public wastewater main (affected by the accessway of a new car park)
 - Stormwater lead catchpit at the western end of the main entrance
2. New utility requirements:
 - Connection to the Council stormwater network is required
 - Electrical connection for car park lighting
3. Transport:
 - Beach Road is an Arterial Road in the Road Hierarchy of the Unitary Plan. Developing any additional car parking will trigger consent under the Vehicle Access Restriction standards of E27 – Transport of the Unitary Plan.
4. Existing park assets
 - The extent and configuration of the car parks are partly controlled by the location of Rugby 1 and 2.

Constraints to consider

5. Other performance standards:
- Open Space – Sport and Active Recreation Zone:
 - Maximum impervious surface 40%
 - Maximum height of non-security flood lighting 18m.
 - All Options are less than 40% impervious surface of the park, so this is not triggered.
 - Auckland Wide – Chapter E8: Stormwater discharge and diversion:
 - Impervious areas up to 1000m² = permitted activity (Option 3)
 - Impervious areas greater than 1000m² = controlled activity (Option 1 and 2)
 - Auckland Wide – Chapter E9: Stormwater quality – high contaminant generating car parks
 - All Options generate less than 30 additional car parks, so this standard is not triggered.
 - Auckland Wide – Chapter E12: Land disturbance
 - E12.4.1. (A4) – earthworks 500m² to 1000m²: Permitted
 - E12.4.1.(A5) – earthworks 1000m² to 2500m²: Restricted Discretionary Activity (All options)
 - E12.4.1. (A8) – earthworks 500m³ to 1000m³: Permitted
 - Auckland Wide – Chapter E16: Trees in open space zones
 - All trees greater than 4m and a girth greater than 400mm are protected in Open space zones. The trees affected by all Options 1 to 3 are protected.
 - Trimming and works within the protected root zone is a permitted activity
 - Removal of protected trees is a Restricted discretionary activity
 - E12.4.1. (A8) – earthworks 500m³ to 1000m³: Permitted

Other information

1. No public or mana whenua consultation has been carried out to date.
2. Early indications from Principal Sport Parks Advisor, based on the current information, is that the development of a car park at Southern Park would not be supported using growth funding.

Next steps

- Local board to consider the presented options and indicate a preference for developed design
- Local board to consider funding allocation
- If the local board wish to proceed to developed design, Auckland Council staff to program developed design in to FY26 work programme



Item 3

Attachment B

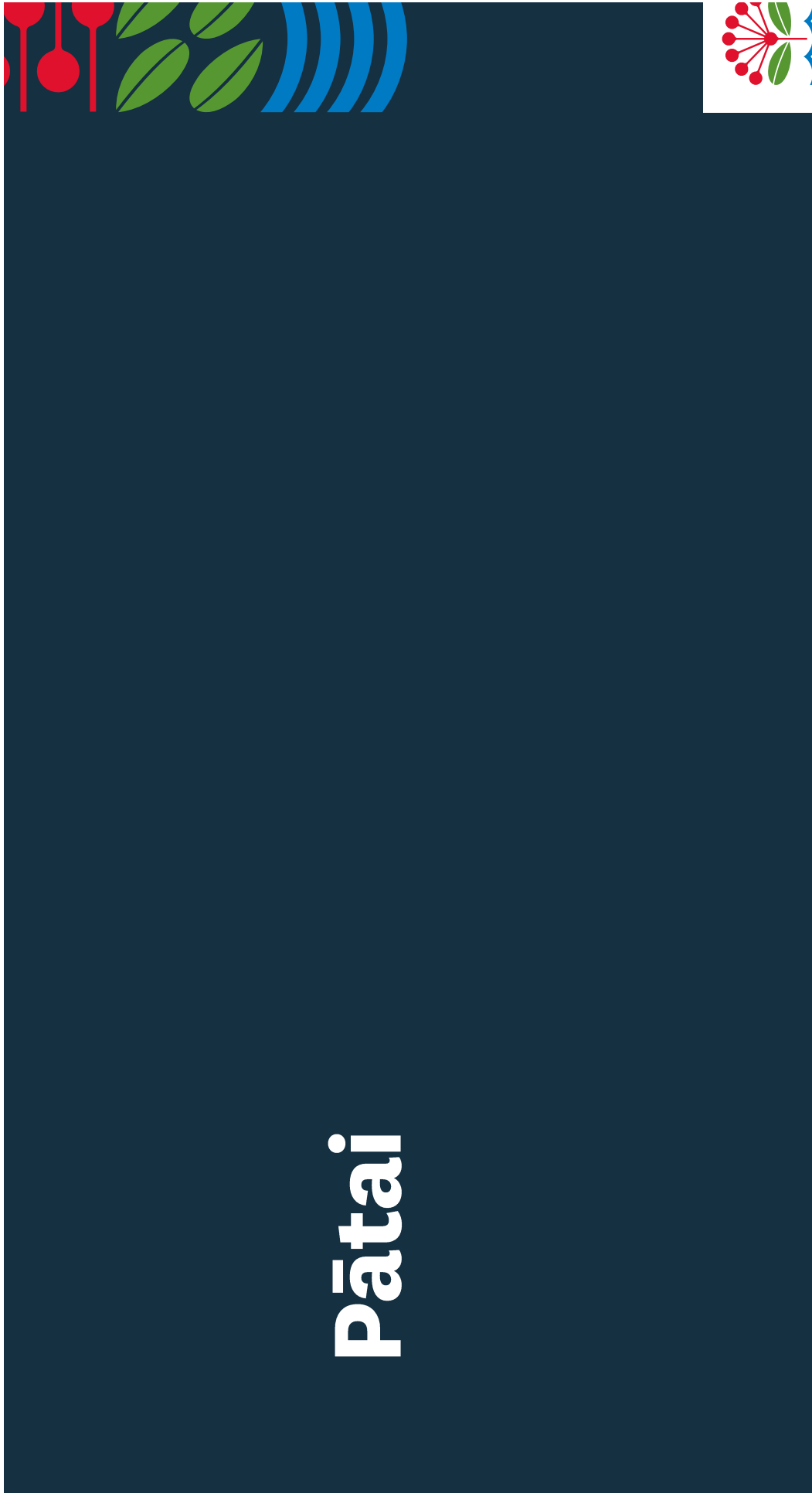

Memorandum

30/04/2025

To: Papakura Local Board
Subject: Draft Papakura Sport & Active Recreation Facilities
From: Barry George
Contact information: barry.george@aucklandcouncil.govt.nz

Purpose

1. To seek local board feedback on the Draft Papakura Sport and Active Recreation Facilities Plan.

Executive Summary

2. Sport and active recreation facilities plans provide strategic guidance to inform decision-making regarding investment, advocacy, partnerships, and opportunities within the sport and recreation facility network.
3. The Draft Papakura Sport and Active Recreation Facilities Plan outlines the current network of sport and active recreation facilities across Papakura (irrespective of ownership) and identifies existing and future provision challenges and needs.
4. On 26 June 2024, Papakura Local board approved the Customer and Community Services Work Programme, including item 4120: Development of the Papakura Sport and Active Recreation Facilities Plan [PPK/2024/79].
6. Visitor Solutions led an extensive community consultation phase, administered in collaboration with CLM Community Sport, which has shaped the findings presented within the draft plan.
7. Following extensive community consultation and the analysis of findings, a full range of capital developments, repair and maintenance, and spatial/master planning projects were prioritised.
8. In total, 32 projects were independently assessed and categorised as local projects or advocacy projects of sub-regional or regional nature.
9. Staff request local board feedback on the Draft Papakura Sport and Active Recreation Facilities Plan is provided verbally during the 7 May 2025 workshop or via email by 21 May 2025.

Context

Sport and active recreation facilities plans

10. Sport and active recreation facilities plans provide strategic guidance to inform decision-making regarding investment, advocacy, partnerships, and opportunities within the sport and recreation facility network.
11. The Draft Papakura Sport and Active Recreation Facilities Plan (the draft plan) outlines the current network of sport and active recreation facilities across Papakura (irrespective of ownership) and identifies existing and future provision challenges and needs.

Page 1

12. Key outputs from the draft plan include:

- consolidated inventory of sport and active recreation facilities
- themes and trends of local facility needs and issues
- assessment of potential impacts of demographic and infrastructure changes
- identification of gaps in facility provision against current and future needs
- prioritised list of projects/opportunities to provide clear direction to support advocacy, resource allocation and leasing decisions

Scope and development of the draft plan

13. On 26 June 2024, the Papakura Local Board approved the Customer and Community Services Work Programme, including item 4120: Development of the Papakura Sport and Active Recreation Facilities Plan (PPK/2024/79).
14. The development of the Papakura Sport and Active Recreation Facilities Plan has been co-funded by Sport New Zealand, who contributed \$25,000, administered through their regional partner Aktive, and the Papakura Local Board through an allocation of \$25,000 from the Locally Driven Initiatives operational budget.
15. The local board gave direction on the scope for the draft Papakura Sport and Active Recreation Facilities Plan in an August 2024 workshop.

The draft plan, guided by the approved scope, illustrates the large variety of facility types which are owned by a range of providers including but not limited to council, private, Ministry of Education, clubs, and charitable trusts.
16. A project steering group was setup to provide a holistic lens on development of the draft plan. The group consisted of staff from Local Board Services, Parks and Community Facilities, and Active Communities, complemented by mana whenua representatives and Community Leisure Management Limited (CLM) Community Sport.
17. Staff presented a project overview at the August 2022 Mana Whenua Forum where iwi in attendance were offered the opportunity for further engagement. Both Te Ākitai Waiohū and Ngaati Whanaunga provided guiding principles of kaitiakitanga and early engagement, and five key considerations for facility projects:
 - Accessibility
 - Hubbing
 - Location
 - Cost
 - Cultural areas of significance
18. Visitor Solutions Limited (VS) was appointed to develop the plan.
19. VS led an extensive community consultation phase, administered in collaboration with CLM Community Sport, which has shaped the findings presented within the draft plan.

Discussion

Uniquely Papakura

20. There is a diverse range of sport and active recreation facilities provided within the Papakura Local Board area with facilities ranging from local through to regional specification. There are:

- Sportsfields - 13 public, four school accessible
 - Indoor courts – eight public, 6.75 Schools, five badminton, four squash
 - Outdoor courts - 13 tennis, 27 netball, 18 basketball, one volleyball
 - Other outdoor – five bowls, four croquet
 - Aquatic - one public, one private
 - A dedicated regional gymnastics facility
 - General exercise - six formal paths, three fitness equipment sites
21. There are a number of traditional sporting clubs such as football, netball, hockey, rugby, rugby league and cricket complimented by emerging codes and activities aligned to the ethnic make-up of the area, for example, kilikiti.
22. The communities are serviced with indoor court facilities and indoor and outdoor aquatic facilities in the Papakura area. There is also provision of popular active recreation facilities such as outdoor basketball and volleyball courts and skate parks throughout the local board area.
23. Participation data has been analysed to support community insights and help prioritise infrastructure requirements at current and into the future.
24. What the data is telling us about the area:
- There are more inactive people in the area (29 per cent) when compared with national benchmarks (23 per cent). Higher inactivity associated with young families (45 per cent) than nationally (28 per cent)
 - There are significant differences in participation rates based on ethnicity and deprivation levels. Inactivity is more pronounced east of the southern motorway. Higher inactivity levels are evident with māori and asian ethnicities.
 - The most popular activities across most age groups are active recreation opportunities (walking, jogging, general play and swimming), not organised sport.
 - There are significant differences in participation levels and choices based on the life stages of individuals. There are high levels of participation for school-aged participants, yet high levels of inactivity amongst young adults.
25. A summary of high-level facility considerations can be found in the table below.

Table 1: Facility considerations

Consideration	Overview
Multisport offerings	The hubbing of assets allows operational cost efficiencies across user groups, where compatibility allows a reduction in capital investment required, and supports whānau to participate in multiple offerings
Ageing club infrastructure	A growing number of sites have maintenance and renewals issues due to the age of assets. Community and council will need to work in partnership to address facility issues in a strategic manner.
Quality of sportsfields	Regional data illustrates the local board area has high shortfalls in field and floodlighting provision. Fields are integral to a number of high participation sports and also offer spaces for informal recreation.
Active recreation provision	There is growing participation in 'pick-up play' opportunities for example basketball half-courts and spaces compatible for volleyball. Free outdoor exercise stations are also gaining appeal.
Optimising utilisation	Activating our places and spaces is a key challenge for our sector. The planning and design of infrastructure should promote the activation of parks or assets ensuring land is retained to realise the benefits of an active community.
Fit-for-purpose utilisation	In some instances, historic occupancy of clubs, supported by rollover leases, has meant the use of land or assets has not matched community need.
Vandalism of sportsfields	The growing prevalence of dirt bikes has caused frustration among the community sport network and has come at a large financial cost to landowners to repair damages.
Connection of network	There are opportunities for active recreation offerings to be improved through the connection of sports parks and key facilities.

Priority projects and guiding principles

26. Priority projects have been assessed using four guiding principles, derived from [Increasing Aucklanders' Participation in Sport: Investment Plan 2019-2039](#) and supported by a series of components identified through the community consultation phase.

- Equity
- Outcome focused
- Achievability
- Sustainability

Mana whenua engagement

27. Te Ākitai Waiohū and Ngaati Whanaunga have played an important role in the development of the draft plan and shaping specific high-level considerations of significance to mana whenua.



28. When looking to progress development projects, it is important lead organisations consider a multitude of factors, including but not limited to:

- environmental impact
- sustainable design, construction, and land management practices
- investigation of efficiencies
- incorporation of climate change mitigation and adaption measures
- inclusion of māori narrative and place names.

29. It should be noted projects will vary in nature and some or all of the above considerations may not be applicable. However an underlying principle of kaitiakitanga should be applied wherever possible.

Priority projects and opportunities

30. Following extensive community consultation and the analysis of findings, a full range of capital developments, repair and maintenance, and spatial/master planning projects were prioritised.

31. In total, 32 projects were independently assessed and categorised as local projects or advocacy projects of sub-regional or regional nature.

32. The priority projects list offers an independent evaluation of prioritised local need at a single moment in time, interpretation of the list should be supported by present-day quality advice.

Table 2: High priority local projects – Snapshot

Group or site	High priority project or opportunity
Prince Edward Park	Changing room upgrades
Bruce Pulman Park	Sports field condition improvements
Papakura Tennis & Squash Club	Court surface upgrade and reconfiguration
Drury Sports Complex	New floodlight provision
Bruce Pulman Park	Indoor cricket net development
Opaheke Sports Park	Staged development of the park
Ray Phillips Badminton Centre	Building refurbishment and court extension
Papakura High School	Optimising covered courts
Drury Sports Complex	Sport and Recreation hub development
Wheel Study	Review on wheel-based demand and facilities

33. A full list of priority projects can be found within the draft plan (Appendix D) with supporting rationale and proposed project actions with indicative costs.



Implementation

34. Registering as a priority project should not be considered an indication of financial support by Papakura Local Board and it is not expected that the local board or Auckland Council leads nor funds, to any degree, any of the priority projects identified.
35. The plan is designed to guide advocacy to leverage regional or external funding for projects, assist with partnership opportunities which may increase accessibility of facilities or unlock further funding, and support the direct investment into community owned facilities.
36. Findings from the plan should also inform future work programme decisions across the broader council sporting infrastructure network.
37. The plan recognises that whilst the local board plays an integral role in the community sport facilities network, implementation will require a diverse mix of funders through a partnership approach.
38. Auckland Council supports the sector in a number of ways including investment through the Sport and Recreation Facility Investment Fund. The contestable fund will invest circa \$185 million over ten years to proactively address sport and recreation infrastructure shortfalls, respond to changing participation preferences, and aim to get more Aucklanders more active, more often.
39. The plan can be used to support advocacy of projects seeking regional funding by providing project context, evidence of strategic alignment, and an independent assessment on local priority.
40. Several local boards have formally adopted a sport and active recreation facilities plan and allocated budget for the implementation of project actions in the form of non-contestable community grants.
41. The staff recommended implementation budget proposed for 2025/2026 of \$100,000.00.

Next steps

42. Staff request local board feedback on the Papakura Sport and Active Recreation Facilities Plan during the 7 May 2025 workshop or via email by 21 May 2025.
43. Should the local board endorse the draft plan in principle, pending minor amendments, staff will present a report to the 20 June 2025 business meeting for formal adoption of the plan.

Attachments

Attachment A – Draft Papakura Sport and Active Recreation Facilities Plan



PAPAKURA LOCAL BOARD WORKSHOP
MAY 2025



Item 3

Attachment E

OUTCOMES & OUTPUTS

- Provide a **consolidated inventory** of sport and active recreation facilities.
- Provide an understanding of local facility **needs and issues**.
- Assess the **potential impacts** of demographic and infrastructure changes.
- Identify **gaps** in facility provision against current and future needs, along with **facility projects** and **potential opportunities**.
- Provide a **framework** for prioritising projects/potential opportunities for further analysis and assessment.
- **Prioritise** the list of projects/opportunities to provide clear direction to support advocacy, resource allocation and leasing decisions.
- Designed to be a **'live' tool** to maintain relevancy.

- The plan is **not intended to be a funding plan** for the Local Board.
- Identification of priority projects **does not guarantee financial support** from the Local Board.
- **Does not replace** the need for more **detailed planning and analysis** (i.e. feasibility studies and business cases).

METHODOLOGY

